

1. All plants material shall be Florida No. 1 or better as given in the current Florida Grades and Standards for Nursery Plants 2015. Florida Department of Agriculture and Consumer Services.
2. All plants shall be containerized and shall be grown and improved by the Landscape Architect at place of growth and upon delivery for conformity to specification.
3. All plants shall be true to species and variety and shall conform to measurements specified. All substitutions shall be submitted to the City and the Landscape Architect for final approval.
4. All plants shall be free of any mechanical, light knot and so trained in appearance as to be superior to form, branching and symmetry.
5. Contractor shall notify Sunshine 811 (call 811) for locations of underground utility lines 48 hours prior to planting. Contractor shall be responsible for any damage to underground utilities caused by work commencing any work. Excavation in the vicinity of underground utilities shall be undertaken with care and by hand, if necessary. The Contractor bears full responsibility for this work and disruption or damage to utilities shall be repaired immediately at no expense to Owner.
6. All trees shall be containerized and shall be grown and improved by the Landscape Architect at place of growth and upon delivery for conformity to specification.
7. All trees shall be free of any mechanical, light knot and so trained in appearance as to be superior to form, branching and symmetry.
8. All trees shall have a mulch ring with a depth of 3" and a diameter of 3'-4" around their base. All mulch shall be kept 4" from base of all plant material. Mulch beds shall be 4" deep and 12" wide around the base of all trees.
9. Soil shall be Set Augustine and free of weeds, insects, fungus and disease, laid with alternating and abutting joints.
10. All trees and shrubs shall be backfilled with a suitable planting soil consisting of 50 percent sand and 50 percent compost. All planting pits shall be planted with a minimum of 6" to 18 inches of planting soil around the root ball. Refer to planting details. Planting soil to be backfilled into planting pits by washing in. Planting beds shall be free from road, pea, egg or colored rock, building materials, debris, weeds, and other foreign matter.
11. All sodded areas shall have a minimum of 2" of planting soil as described in item #8.
12. All trees shall be watered by the Contractor and will be healthy and in flourishing condition of active growth one year from date of final acceptance.
13. All shrubs, groundcovers, vines and sod shall be fully warranted for 90 days under same condition as above.
14. All synthetic burlap, synthetic string or cord or wire baskets shall be removed before any trees are installed. All synthetic burlap shall be removed from the trunk, branches, etc. before the trees are installed. The top 1/3 of the trunk shall be cut or cut back into the planting hole before the trees are backfilled. Planting soil to be backfilled into pits by washing in.
15. All trees and palms shall be planted with the top of their rootballs 1"-2" above finished grade. All other plants shall be planted with the top of their rootballs no deeper than the final grade surrounding the planting area.
16. In areas where paved surfaces abut or meet, the final level of both surfaces should be even and sloping shall be installed with feathered edges of planting.
17. All in place paving shall be installed under, workmanship and according to good planting procedures. Installation shall include watering, fertilizing, weeding, selective pruning and removal of debris and debris on a regular basis so as to present a neat and well kept appearance at all times.
18. All landscape and sod areas shall have an automatic irrigation system installed. Coverage should be 100% with 50% minimum overlap using rust free water to all landscape and sod areas. Spray upon sidewalks, streets and adjacent properties and adjacent streets and adjacent streets and adjacent groundcover beds should be on separate irrigation zones for a more efficient system. Irrigation system shall be installed with a rainwash device.
19. All landscape and irrigation shall be installed in compliance with all local codes.
20. The plan shall take precedence over the plant list, should there be any discrepancies between the two.

<b>ZONING DISTRICT:</b> RS-3			
<b>NET LOT AREA:</b> 18,375 sf ( .42 AC)			
<b>OPEN SPACE</b>		<b>Required</b>	<b>Provided</b>
A. Square feet of open space required, as indicated on site plan: Net lot area = 18,375sf x .25%=		4594 sf	8854.74 sf
B. Square feet of parking lot open space required as indicated on site plan: Number of parking spaces 0 x 10 sf per parking space =		0	0
C. Total square feet of landscaped open space required : A+B=		4594 sf	8854.74 sf
<b>TREES</b>			
A. Number of trees required per net lot acre less existing number of trees meeting minimum requirements = 5 + 1 tree/ 1000 sf =		18	18
B. Percentage of native trees required 18 x .30 =		6	10
C. Percentage drought tolerant and low maintenance: 18 x .50		9	10
<b>STREET TREES</b>			
D. Street trees (maximum average spacing of 20' O.C.) 105/ 20		6	6
Street trees located directly beneath power lines (maximum average spacing of 20' O.C.)		6	6
<b>SHRUBS</b>			
A. Number of shrubs required: Number of trees required 24 x 12 =		288	587
B. Percentage of native shrubs required: 288 x .50		144	275
C. Percentage of large shrubs or small trees required: 288 x .10 =		29	29
<b>IRRIGATION:</b> Automatic			

Trees/ Palms		Botanical / Common Name	Size	Native	Drought Tolerance
Sym	Qty				
CD	2	Coccoloba diversifolia/ Pigeon Plum	12' Ht. x 4' Spr., 2" cal.	Yes	High
EE	6	Elaeagnus decipiens/ Japanese Blueberry	12' Ht x 4' Spr, 2" cal	No	Medium
QV	2	Quercus virginiana/ Live Oak	12' Ht x 6' Spr., 2" cal	Yes	High
BS	2	Bursera simaruba/ Gumbo Limbo	12' Ht x 6' Spr, 2" cal	Yes	High
CS	4	Cordia sebestena/ Orange Gelfree Tree	10' Ht x 5' Spr, 1.5" cal	Yes	High
LJ	6	Ligustrum japonicum/ Wax Privet	10' Ht x 5' Spr, multi trunk	No	High
<b>Shrubs/Grundcovers</b>					
CM	25	Caryota mitis/ Fishtail Palm	8' x 4'	No	High
AP	3	Alocasia 'Portora'/ Giant Elephant Ear	30" Ht	No	Low
AI	4	Alocaia 'California'/ California Alocasia	24" x 24", 24" O.C.	No	Low
CF	13	Clusia flava/ Small Leaf Clusia	24" x 24", 24" O.C.	No	High
HD	120	Helianthus debilis/ Beach Sunflower	9" x 10", 18" O.C.	Yes	High
IV	95	Ilex vomitoria 'Stokes Dwarf'/ Dwarf Ilex	10" x 10", 18" O.C.	Yes	High
TF	60	Tripsacum floridana/ Florida Grass Grass	16" x 16", 24" O.C.	Yes	High
NO	32	Nerium oleander 'Petite Pink'/ Dwarf Pink Oleander	20" x 20", 24" O.C.	No	High
FE	4	Furcraea foetida/ Giant Fiske Agave	24" x 24"	No	High
JU	80	Juniperus conferta/ Shore Juniper	8" x 12", 18" O.C.	No	High
PM	124	Podocarpus macrophyllus/ Podocarpus	24" x 24", 24" O.C.	No	Medium
CA	56	Carissa macrocarpa 'Emerald Blanket'/ Dwarf Carissa	24" x 24", 24" O.C.	No	Medium
Sod		St. Augustine			
Mulch		Shredded Melaleuca or Eucalyptus			

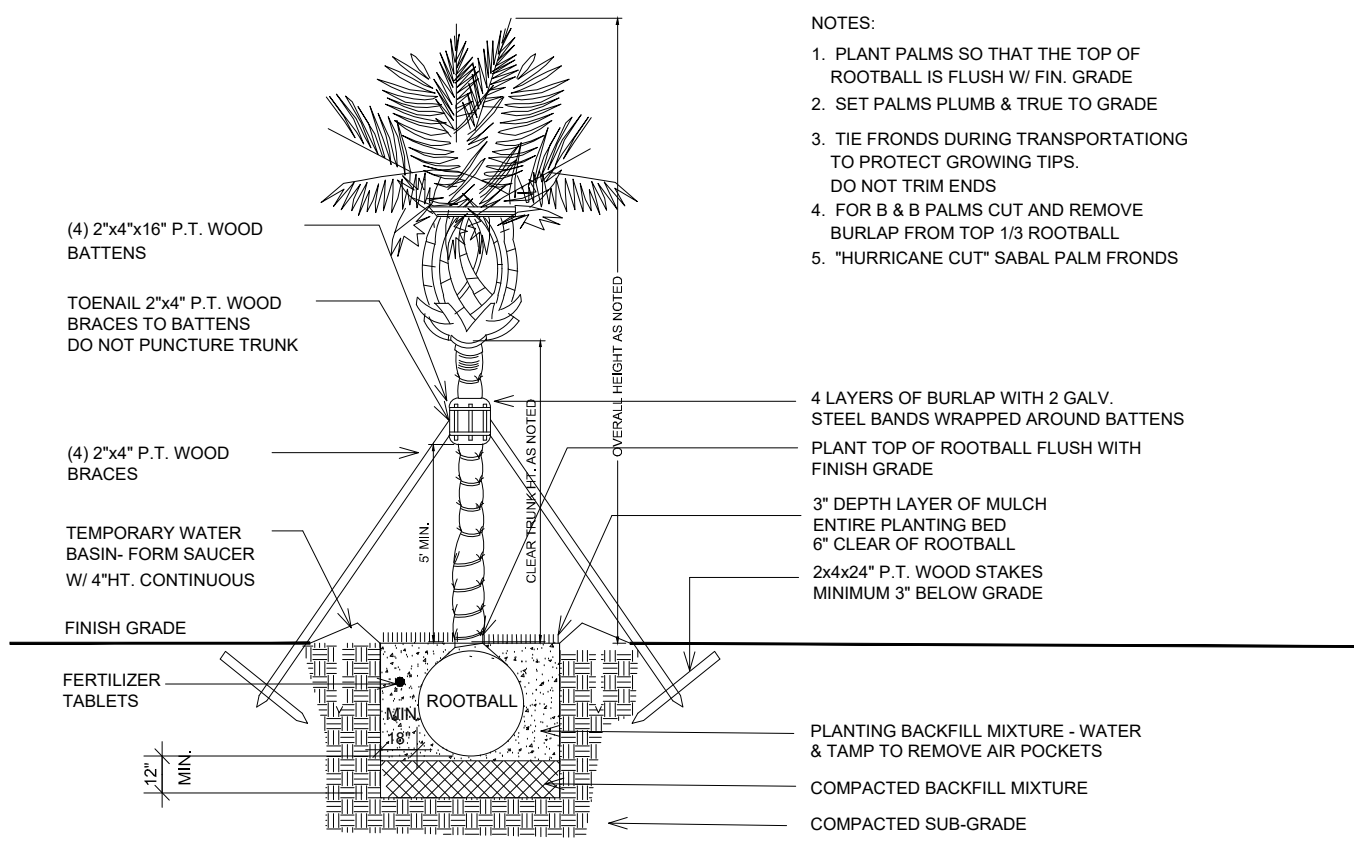

NOTE: NO WELLINGTON TAPE OR OTHER NON-BIODEGRADABLE MATERIALS SHALL COME INTO CONTACT WITH THE TREE.

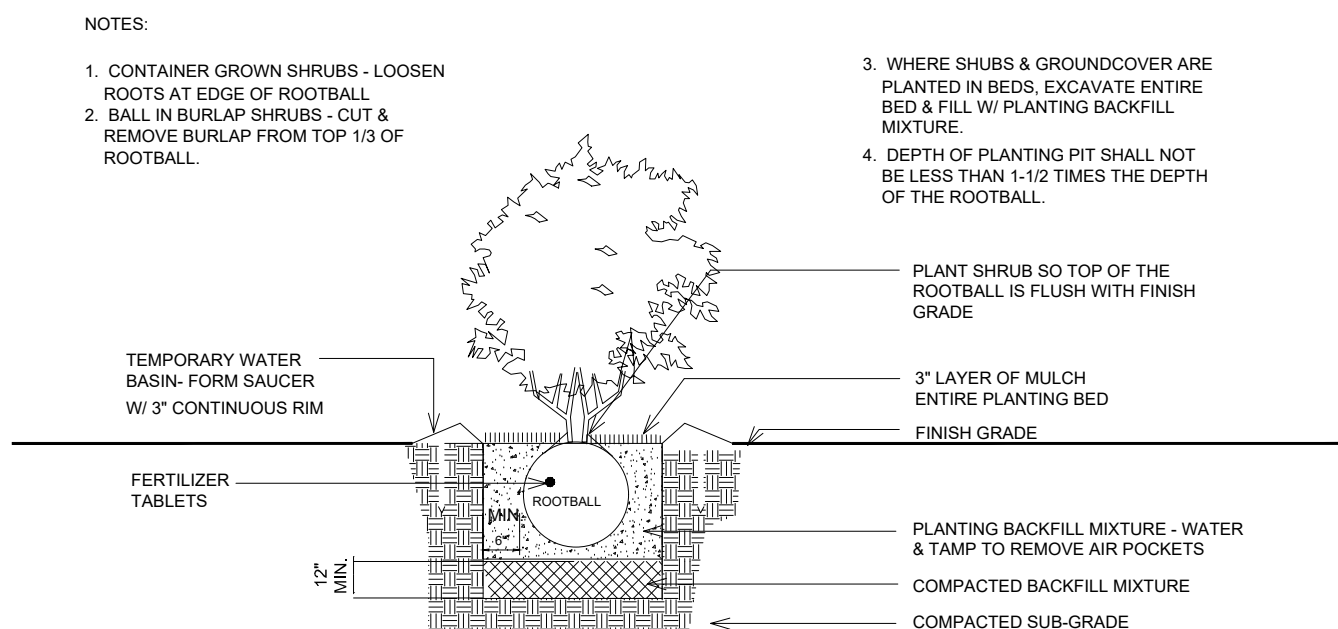

### TREE STAKING DETAIL