

GROUND LEVEL LANDSCAPE PLAN

Scale: 1" = 20'-0"

SHEET INDEX:

- L-1 GROUND FLOOR LANDSCAPE PLAN
- L-2 GROUND FLOOR LANDSCAPE PLAN
- L-3 ROOF LEVEL LANDSCAPE PLAN
- L-4 LANDSCAPE NOTES AND DETAILS

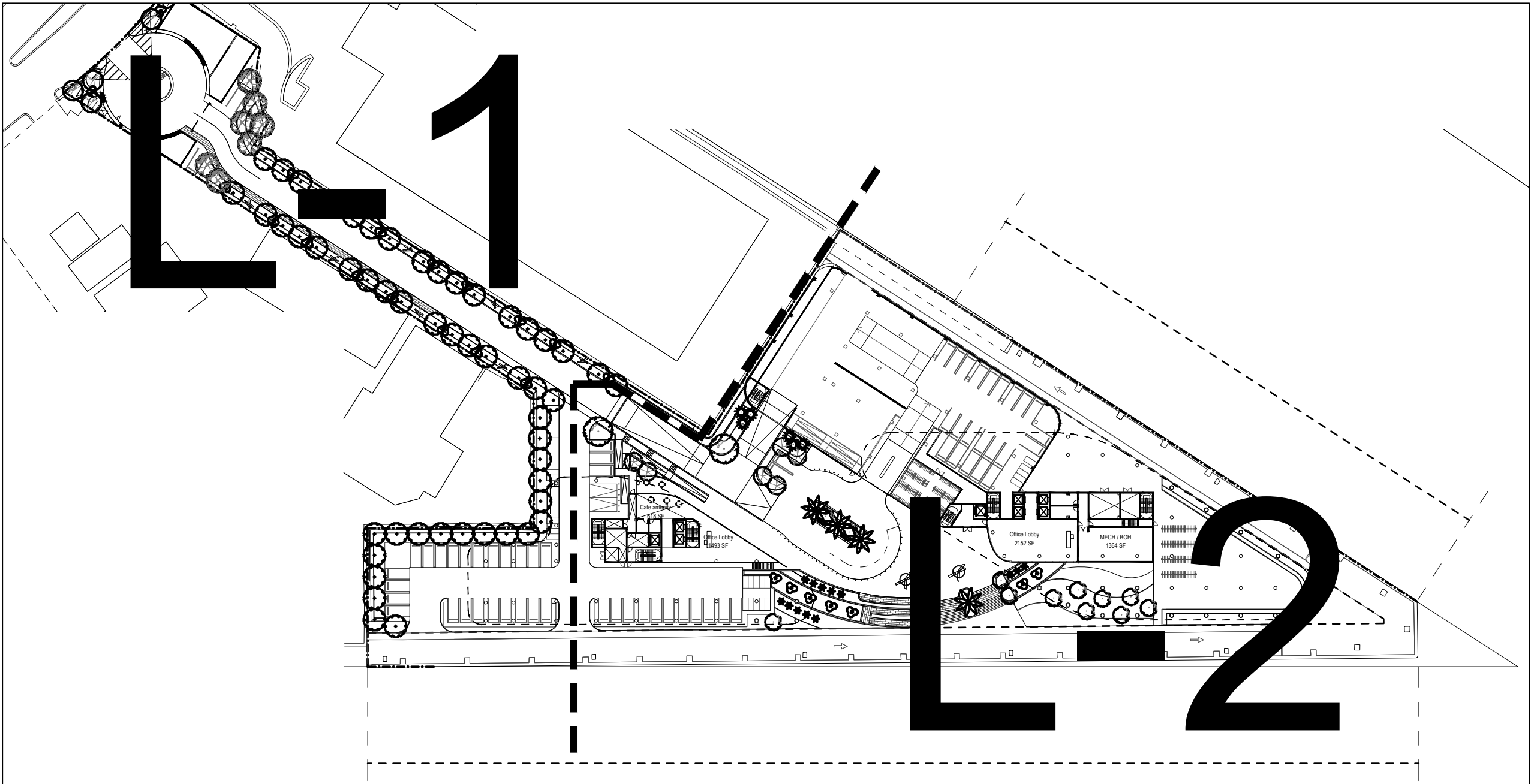

KEY PLAN

Scale: NTS

LANDSCAPE LEGEND CITY OF MIAMI BEACH			
ZONE DISTRICT: I-1 (LIGHT INDUSTRY DISTRICT)			
Lot Area: 161,716 s.f. (3.71 Acres) Water Bodies: 3,934 s.f.			
Landscape Open Space (if applicable) Greenbelt Width (if applicable) Maximum Lawn Area (20%)	REQ. N/A 32,343 s.f.	PROV. N/A 1,655 s.f.	
TREES: Trees per Acre: 22 Note: 30% of required trees shall be native species 50% of the trees shall be low-maintenance and/or drought tolerant Trees allowed on Upper Levels: 25% Max. of Total	80 20	80 2	
PARKING LOT TREES: 1 Tree per 90 Linear Ft. Parking 140	2	2	
STREET TREES: 79 Linear feet along street / 20 = 4	4	4	
TOTAL NUMBER OF TREES: Native Trees (30%) Drought Tolerant Trees (50%)	86 26 44	86 86 86	
SHRUBS: (12 shrubs per each required lot & street tree) = 12 x 86	1,032	3,814	
LARGE SHRUBS: (10% of required shrubs)	103	253	
50% required shrubs shall be native species.	516	3,814	

LANDSCAPE LIST			
TREES/PALMS**			
SYMBOL	QUAN.	PROPOSED MATERIAL	SPECIFICATIONS
AM	8	Adonidia merillii 'Triple' DOUBLE CHRISTMAS PALM	10' OA HT., TRIPLE F.G.
BS	7	Bursera simaruba GUMBO LIMBO	12' HT. X 6" SPR. 2" CAL. F.G.
CR	14	Clusia guttifera SMALL LEAF CLUSIA	12' HT. X 6" SPR. 2" CAL. F.G.
CD	6	Coccoloba diversiflora PIGEON PLUM	12' HT. X 6" SPR. 2" CAL. F.G.
CE	49	Conocarpus erectus GREEN BUTTONWOOD	12' HT. X 6" SPR. 2" CAL. F.G.
CE1	5	Conocarpus erectus 'serotious' SILVER BUTTONWOOD	12-14' HT. X 6" SPR. 3" CAL., 4' MIN. C.T. F.G.
MS	3	Myrcianthes fragrans SIMPSON'S STOPPER	10' HT. X 5" SPR. 1.5" CAL. F.G.
PD	4	Phoenix dactylifera 'Medjool' MEDJOL DATE PALM	12' C.T. TO NUT F.G., SPECIMEN
QV	2	Quercus virginiana LIVE OAK	12' HT. X 6" SPR. 2" CAL. F.G.
SP	6	Sabal palmetto SABAL PALM	6-10' C.T., 10-14' O.A. HTS. F.G., STAGGERED HTS.
TR	23	Thrinax radiata FLORIDA THATCH PALM	6-8' O.A., TRIPLE F.G., TRIPLE TRUNK
SHRUBS AND GROUNDCOVERS			
SYMBOL	QUAN.	PROPOSED MATERIAL	SPECIFICATIONS
AC	96	Aptenia cordifolia 'Variegata' VARIEGATED BABY SUNROSE	8" HT. X 6" SPR. / 6" O.C. 1 GAL.
AD	13	Agave desmetiana SMOOTH BLUE AGAVE	36" HT. X 36" SPR. 15 GAL.
AG	152	Arachis glabrata 'Ecoturf' PERENNIAL PEANUT	12" HT. X 12" SPR. / 18" O.C. 1 GAL.
CG	436	Clusia guttifera SMALL LEAF CLUSIA	36" HT. X 30" SPR. / 30" O.C. 7 GAL.
CG1	212	Clusia guttifera SMALL LEAF CLUSIA	6-7' HT. X 36" SPR. / 36" O.C. 25 GAL.
CI	209	Chrysobalanus icaco 'Red Tip' RED TIP COCOPLUM	20" HT. X 18" SPR. / 24" O.C. 3 GAL.
CH	1,146	Chrysobalanus icaco 'Horizontalis' HORIZONTAL COCOPLUM	18" HT. X 18" SPR. / 24" O.C. 3 GAL.
EL	834	Ernodea littoralis GOLDEN CREEPER	15" HT. X 12" SPR. / 18" O.C. 1 GAL.
FM	1,927	Ficus microcarpa 'Green Island' GREEN ISLAND FICUS	15" HT. X 15" SPR. / 15" O.C. 3 GAL.
PR	99	Pennisetum setaceum 'Cupreum' RED FOUNTAIN GRASS	18" HT. X 18" SPR. / 24" O.C. 3 GAL.
PS	236	Pennisetum setaceum 'Alba' WHITE FOUNTAIN GRASS	18" HT. X 18" SPR. / 24" O.C. 3 GAL.
SB	847	Spartina bakeri SAND CORDGRASS	24" HT. X 24" SPR. / 24" O.C. 3 GAL.
SM	167	Sabal minor DWARF SILVER STEM PALMETTO	30" HT. X 30" SPR. / 36" O.C. 7 GAL.
TD	219	Tripsacum dactyloides FAKAHATCHEE GRASS	30" HT. X 30" SPR. / 36" O.C. 3 GAL.
ZP	355	Zamia pumila COONTIE	18" HT. X 18" SPR. / 24" O.C. 3 GAL.
LAWN	As Required	Stenotaphrum secundatum 'Floratum' ST. AUGUSTINE GRASS	SOLID EVEN SOD

* DENOTES NATIVE SPECIES
** ALL PROPOSED PALMS WERE COUNTED AS LARGE SHRUBS FOR CODE PURPOSES

W

H

P

WITKIN HULTS
+
PARTNERS

307 south 21st avenue hollywood, florida
phone: 954.923.9881 facsimile: 954.923.9889
www.witkindesign.com

©2020 WITKIN HULTS + PARTNERS
THE DESIGN AND DRAWINGS HEREIN ARE THE
INTELLECTUAL PROPERTY OF THIS
LANDSCAPE ARCHITECT AND ARE PROTECTED
UNDER THE COPYRIGHT PROTECTION ACT

Project:

Revisions:

Date:

By:

1. PSB Submittal

12-04-2020

EWS

Seal:

Lic. # LA0000889

Member: A.S.L.A.

Drawing: GROUND LEVEL
LANDSCAPE PLAN

Date: 11/05/2020

Scale: See Left

Drawn by: EWS

Sheet No.:

L-1

Cad Id.: 2020-000

