

- PROPOSED PROGRAM
- BACK OF HOUSE AREAS
- EXISTING STRUCTURE, WALLS, AND PARTITION
- PROPOSED STRUCTURE, WALLS, AND PARTITION

North Tower Sheet Notes -...	
1	Proposed Storefront/Glazing
2	Relocated Stairs
3	Proposed Elevator To Mezzanine Level

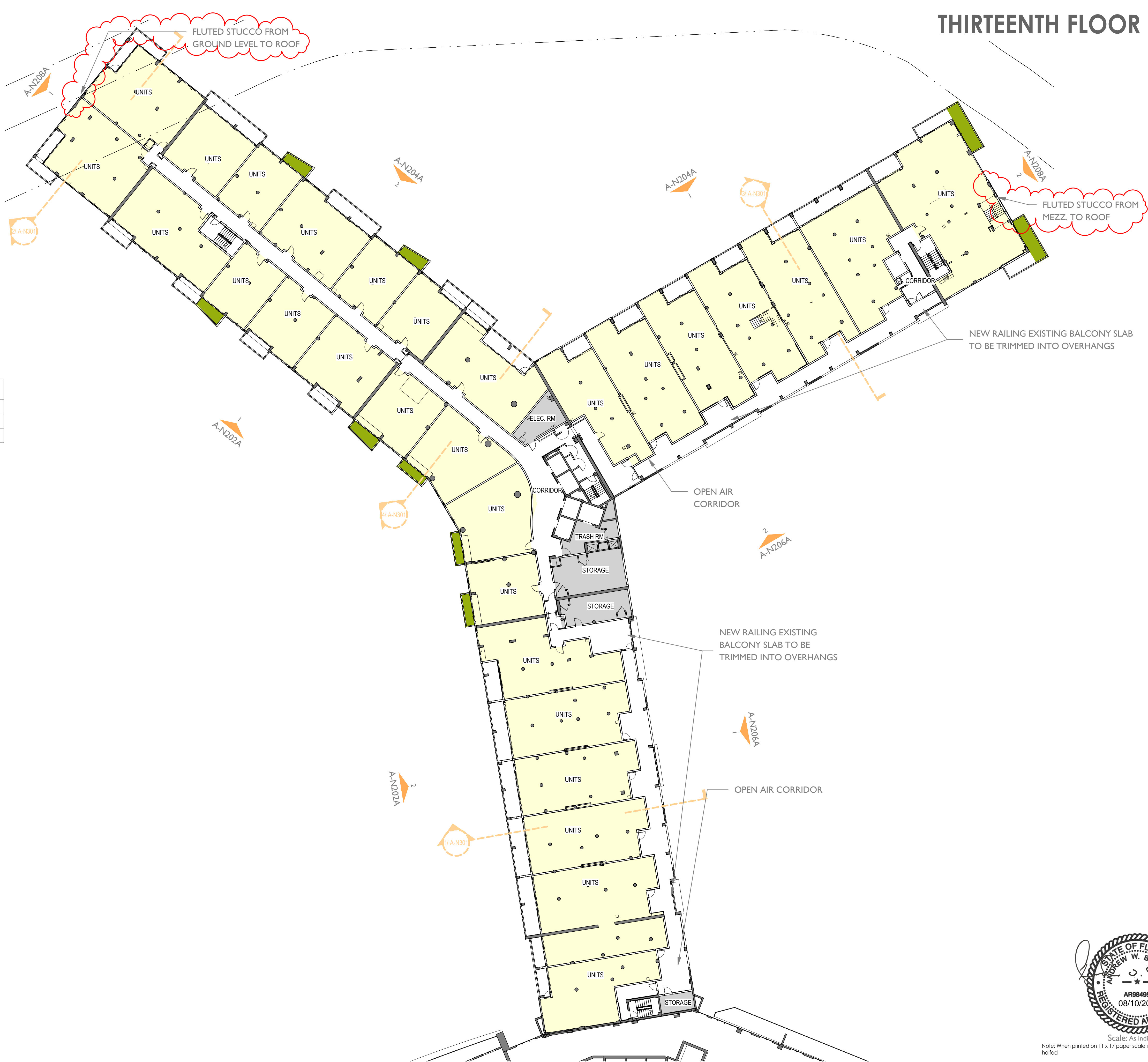

THIRTEENTH FLOOR PLAN - PROPOSED

FLAMINGO
1420 BAY ROAD, MIAMI BEACH

Stantec Architecture Inc - AA26000733
Andrew Burnett Lic. # AR98495



Stantec Architecture Inc.
One Biscayne Tower Suite 1670
2 South Biscayne Boulevard
Miami, FL 33131-1804
Tel: (305) 482-8700 / Fax: (305) 482-8770

DRB SUBMITTAL

08.03.2017

Revision
08-10-2020

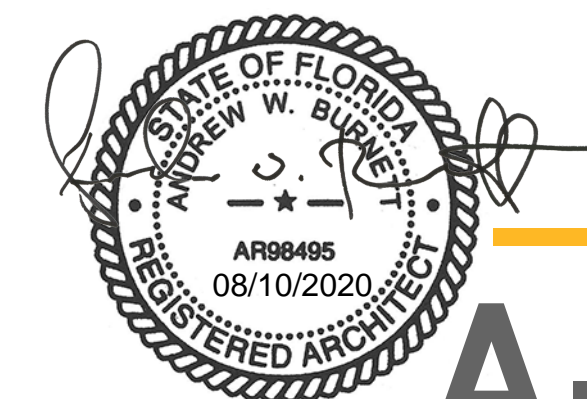

Copyright Reserved

A-N112B

Level I3 - Proposed
SCALE: 3/64" = 1'-0"

Note: When printed on 11 x 17 paper scale is halved

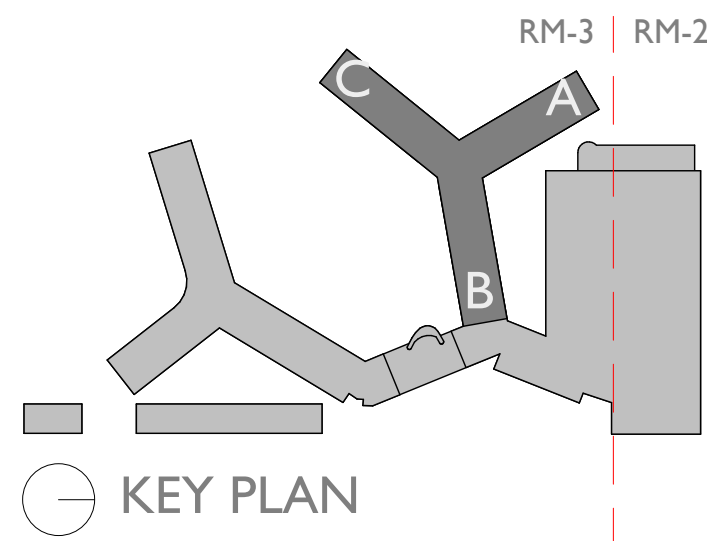

- PROPOSED PROGRAM
- BACK OF HOUSE AREAS
- EXISTING STRUCTURE, WALLS, AND PARTITION
- PROPOSED STRUCTURE, WALLS, AND PARTITION
- PROPOSED WATER FEATURES
- PROPOSED LANDSCAPE

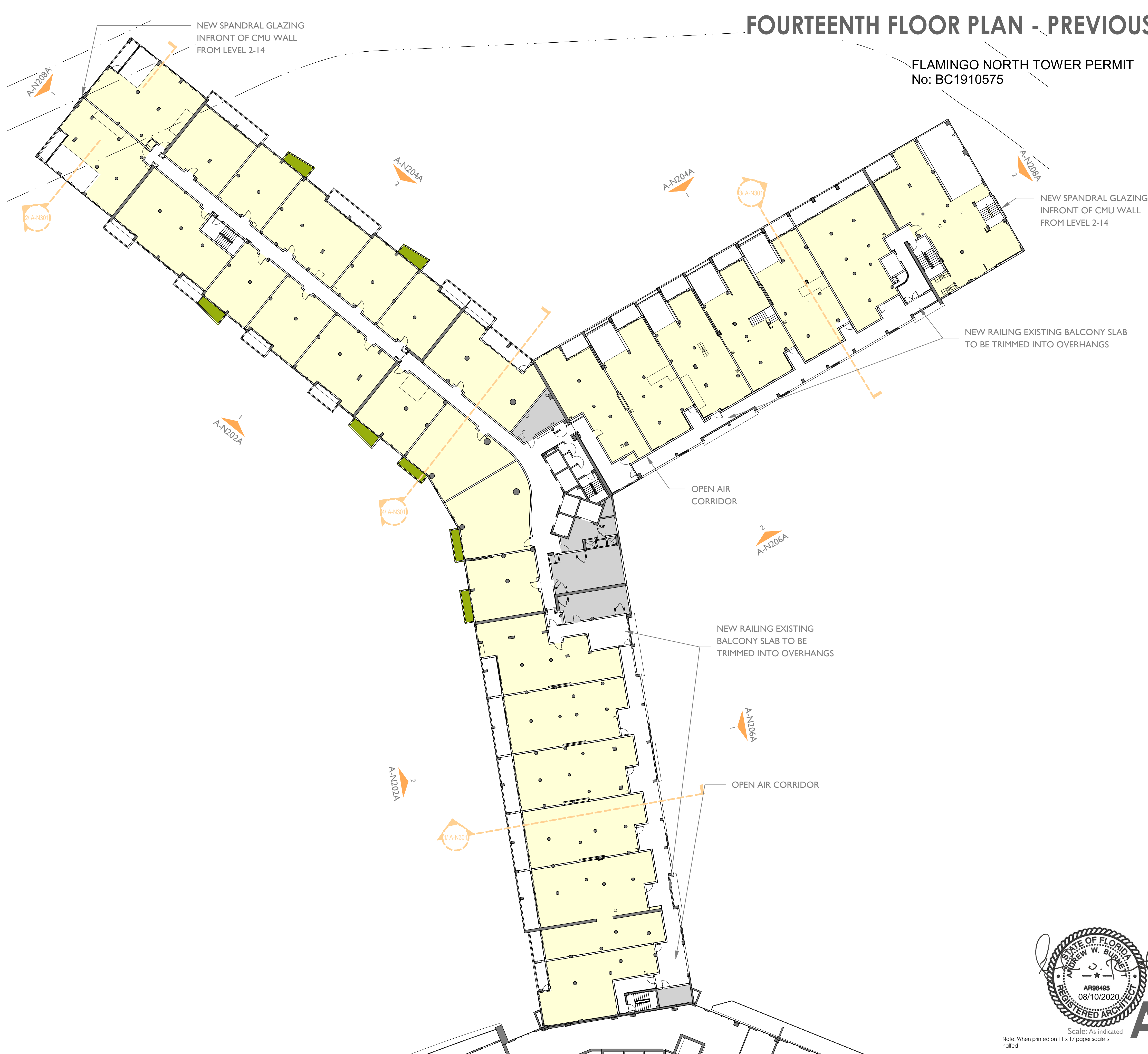

FOURTEENTH FLOOR PLAN - PREVIOUSLY APPROVED

FLAMINGO NORTH TOWER PERMIT
No: BC1910575

FLAMINGO
1420 BAY ROAD, MIAMI BEACH

Stantec Architecture Inc - AA26000733
Andrew Burnett Lic. # AR98495



Stantec Architecture Inc.
One Biscayne Tower Suite 1670
2 South Biscayne Boulevard
Miami, FL 33131-1804
Tel: (305) 482-8700 / Fax: (305) 482-8770

DRB SUBMITTAL

08.03.2017

Revision

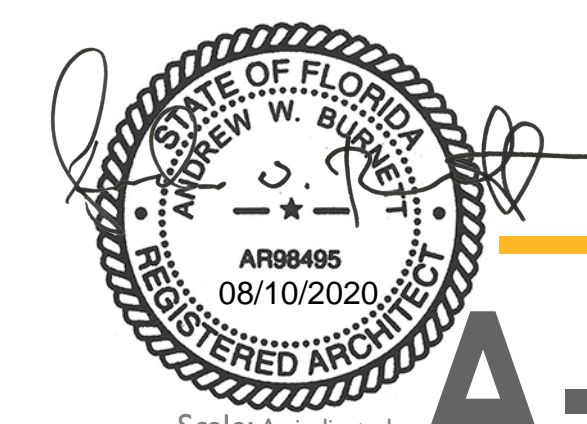

Copyright Reserved

A-N114A

Level 14 - Approved
SCALE: 3/64" = 1'-0"

Note: When printed on 11 x 17 paper scale is halved