

FLAMINGO PHASE LEGEND

- PHASE I (BC1897183) - PEDESTRIAN PLAZA, NORTH AND SOUTH DROP-OFF, GROUND AND THIRD LEVEL CENTRAL TOWER RENOVATION: BUILDING PERMIT WITHIN EIGHTEEN (18) MONTHS OF DRB ORDER DRB-0160. **COMPLETED**
- PHASE II (BC1808437) - NORTH GARAGE & COURTYARD: BUILDING PERMIT WITHIN SIX (6) MONTHS OF PHASE I BUILDING PERMIT. **PERMITTED AND IN CONSTRUCTION**
- PHASE III (BC1910575) - NORTH POOL & OUTDOOR AREA: BUILDING PERMIT WITHIN TWELVE (12) MONTHS OF PHASE II BUILDING PERMIT. **PERMITTED AND IN CONSTRUCTION**
- PHASE IV (BC1910575) - NORTH TOWER RENOVATION: BUILDING PERMIT WITHIN TWELVE (12) MONTHS OF PHASE III BUILDING PERMIT. **PERMITTED AND IN CONSTRUCTION**
- PHASE 5 - NEW GARDEN APARTMENTS: **PROPOSED**

PROPOSED SITE - PHASING PLAN

FLAMINGO
1420 BAY ROAD, MIAMI BEACH

Stantec Architecture Inc - AA26000733
Andrew Burnett Lic. # AR98495

Stantec

Stantec Architecture Inc.
One Biscayne Tower Suite 1670
2 South Biscayne Boulevard
Miami, FL 33131-1804
Tel: (305) 482-8700 / Fax: (305) 482-8770

DRB SUBMITTAL

01.05.2018

Revision

08-10-2020

Copyright Reserved

G7E

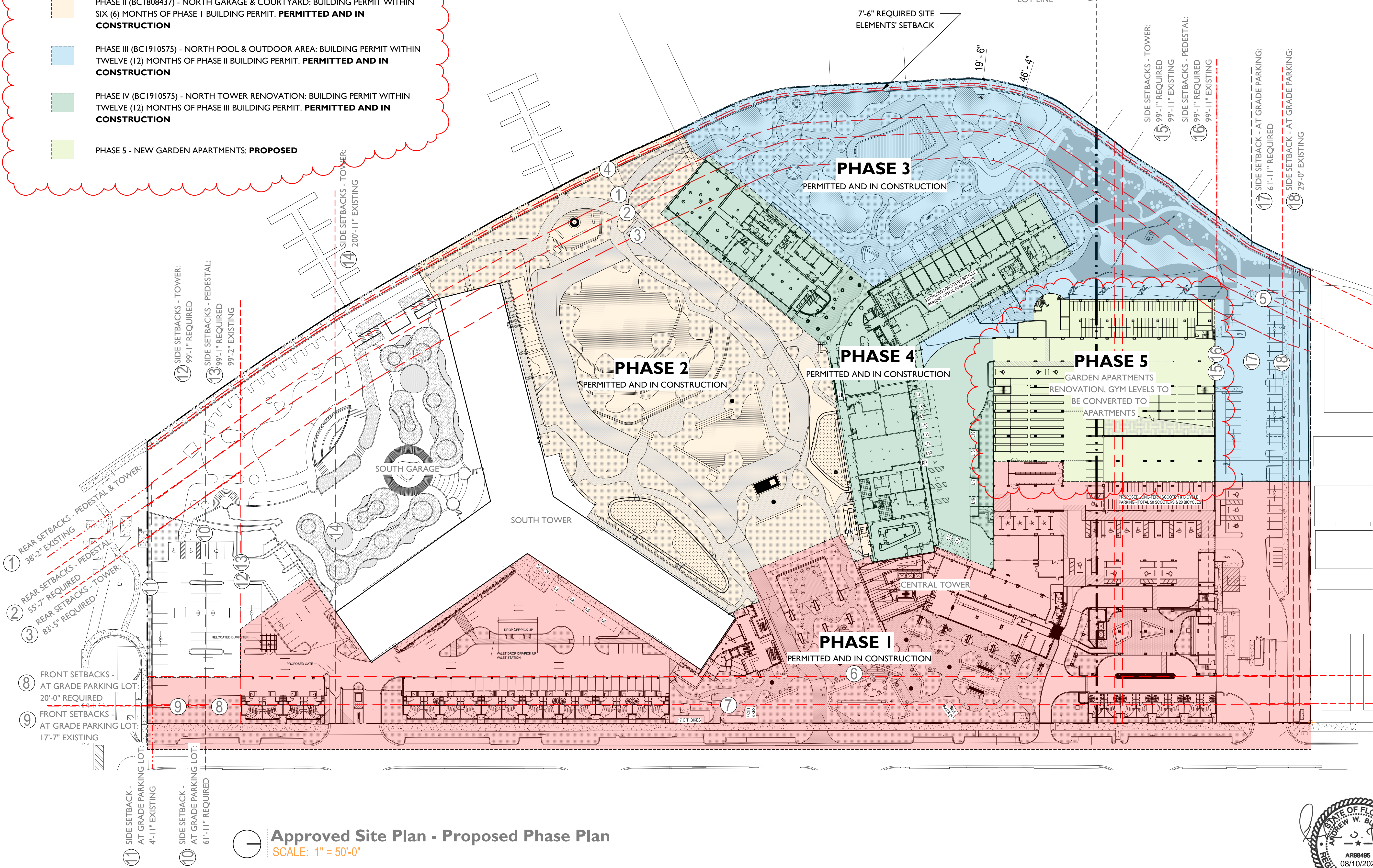

Approved Site Plan - Proposed Phase Plan
SCALE: 1" = 50'-0"

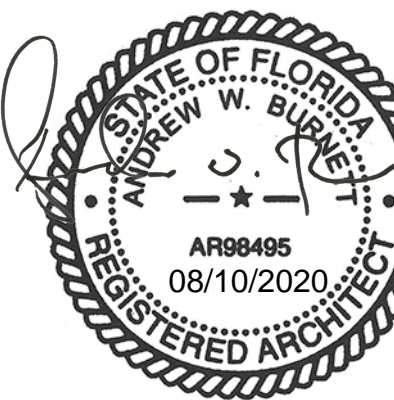

Note: When printed on 11 x 17 paper scale is halved

COLORED SITE PLAN

FLAMINGO

1420 BAY ROAD, MIAMI BEACH

Stantec Architecture Inc - AA26000733
Jonathan Cardello Lic. # AR93391

Stantec Architecture Inc.
One Biscayne Tower Suite 1670
2 South Biscayne Boulevard
Miami, FL 33131-1804
Tel: (305) 482-8700 / Fax: (305) 482-8770



DRB SUBMITTAL

08.03.2017

Revision
10-06-2017

Copyright Reserved

G8



COLORED SITE PLAN

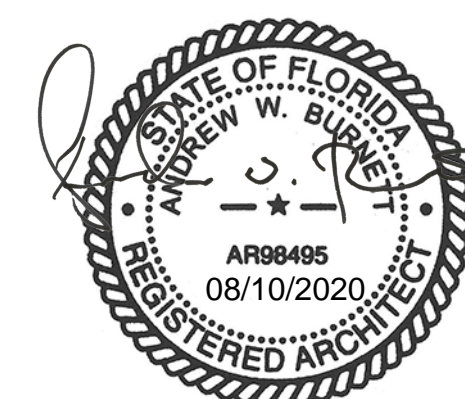

Scale:
Note: When printed on 11 x 17 paper scale is halved