

ZONING DATA - RS-4					
	REQUIRED	PROVIDED		REQUIRED	PROVIDED
LOT AREA	6,000 SQ. FT. MINIMUM	7,320 SQ. FT.	POOL REAR SETBACK	7'-6"	4'-0" *
LOT WIDTH	50' MINIMUM	60'	POOL INTERIOR (S.W.) SIDE SETBACK	9'-0"	12'-0"
LOT COVERAGE	3,360 SQ. FT. (@ 50% OF LOT AREA)	2,800 SQ. FT.	POOL INTERIOR (N.E.) SIDE SETBACK	9'-0"	6'-0" *
			POOL FRONT SETBACK	20'-0"	107'-9"
PERVIOUS AREA @ REAR LOT	840 SQ. FT. (@ 70% OF 1,200 SQ. FT. @ REAR 20')	877 SQ. FT. (489 SOD + 388 BELOW-GRADE POOL)	DECK REAR SETBACK	6'-0"	3'-6" *
			DECK INTERIOR (S.W.) SIDE SETBACK	7'-6"	6'-10" *
			DECK INTERIOR (N.E.) SIDE SETBACK	7'-6"	3'-9" *
			DECK FRONT SETBACK	20'-0"	101'-8"
			EQUIPMENT SETBACK	5'-0"	8'-6"

* PER APPROVED VARIANCE

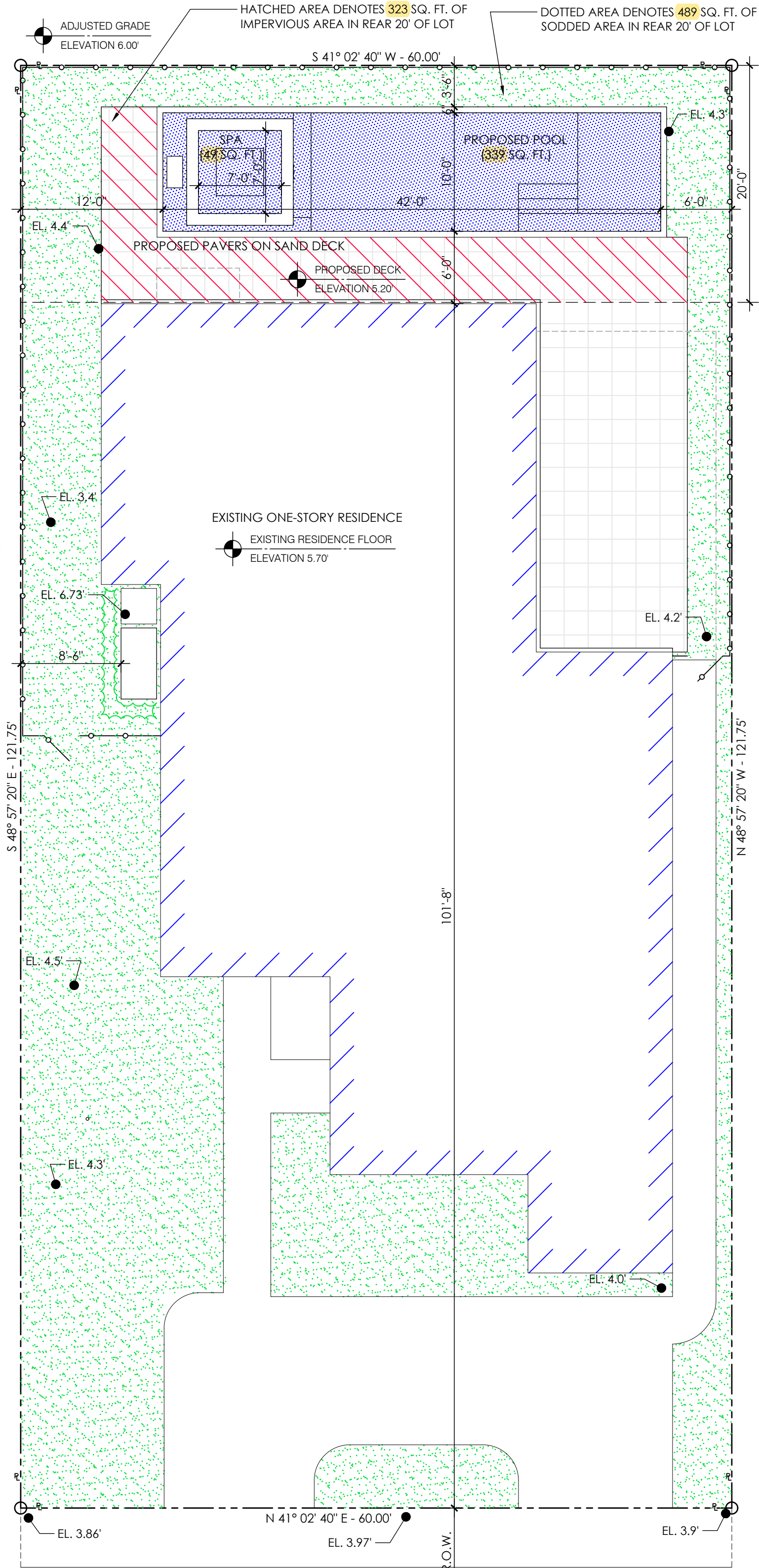

LEGAL DESCRIPTION:
LOT 6, BLOCK 16 OF AMENDED PLAT OF SUNSET LAKE
SUBDIVISION ACCORDING TO THE PLAT THEREOF AS
RECORDED IN PLAT BOOK 8 - PAGE 52 OF THE PUBLIC
RECORDS OF MIAMI-DADE COUNTY, FLORIDA

ALTON ROAD



SITE PLAN
SCALE: 1/8" = 1'-0"

WAYNE MARKHAM BENNETT, P.E. #57216
265 S. FEDERAL HWY. #109 - DEERFIELD BEACH, FL 33441
(954) 818-3825 - wmb@wmb-pe.com

If signed digitally above, printed copies of this document are not considered signed and sealed and the signature must be verified on any electronic copies.

LOT COVERAGE
CALCULATIONS

PROJECT NAME:
CARVAJAL RESIDENCE

2034 ALTON ROAD
MIAMI BEACH, FLORIDA 33140

CONTRACTOR:
ESSIG POOLS INC

10111 BUSINESS DRIVE
MIRAMAR, FLORIDA 33025
305-949-0000

REVISIONS:

DRAWN BY: L.L.
CHECKED BY: A.E.

