



| | |
|--------|-----|
| TOTAL: | 568 |
|--------|-----|

TREE MITIGATION:
 Replacing 568 sq.ft. of canopy with 600 sq.ft. as shown:
 1 Live Oak (cat 1 tree - 300 ea) = 300 sq.ft.
 1 Green Buttonwood (cat 1 tree - 300 ea) = 300 sq.ft.

Remaining trees to be relocated on site. See Planting Plan for locations.



| | |
|--------|-----|
| TOTAL: | 568 |
|--------|-----|

TREE MITIGATION:
 Replacing 568 sq.ft. of canopy with 600 sq.ft. as shown:
 1 Live Oak (cat 1 tree - 300 ea) = 300 sq.ft.
 1 Green Buttonwood (cat 1 tree - 300 ea) = 300 sq.ft.

Remaining trees to be relocated on site. See Planting Plan for locations.

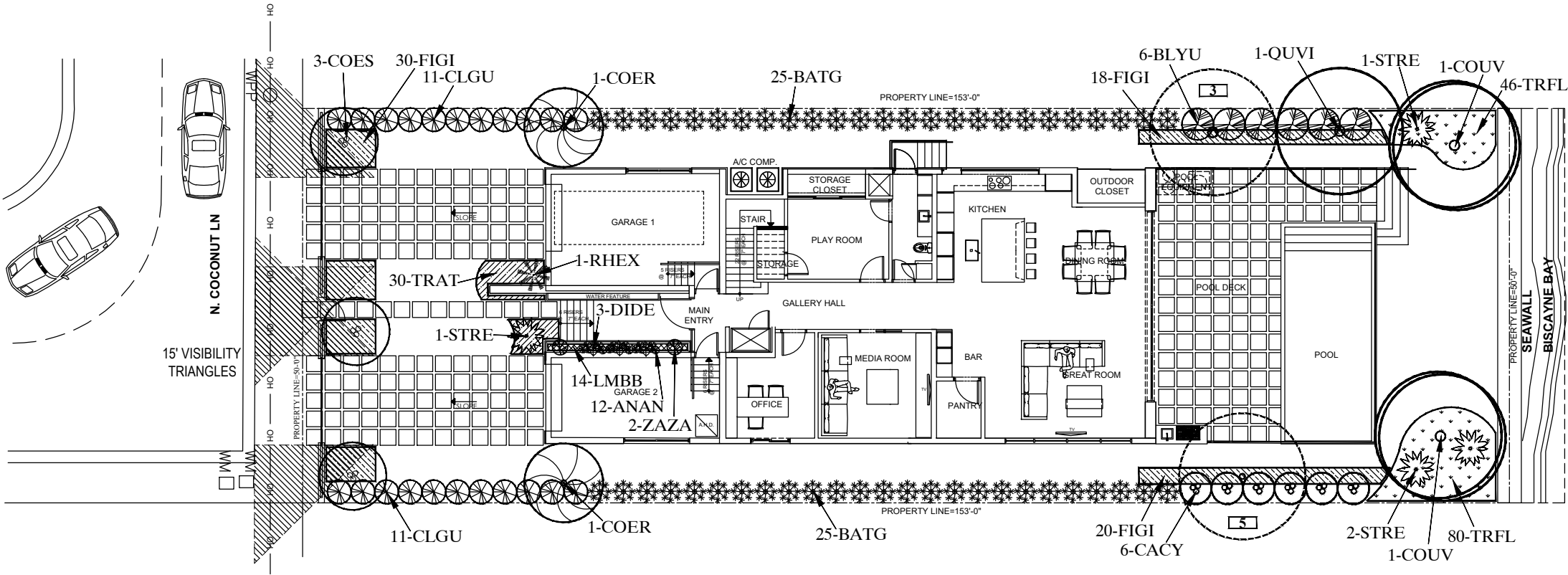

EASEMENT NOTE:

Per CMB Public Works Department, only sod is permitted within any easement on the property. As there are no easements located within this property, this condition is not shown.

LANDSCAPE NOTES

1. All plant material to be Florida No.1 or better per most current version of "Grades and Standards for Nursery Plants, Part I and II," prepared by the State of Florida Department of Agriculture and Consumer Services.
2. All planting beds to be topped with 2" min. mulch "Grade A", unless otherwise noted. A two-inch layer, after watering in, of mulch must be placed and maintained around all newly installed trees, shrubs, and ground cover plantings. Each tree must have a ring of mulch no less than 24 inches beyond its' trunk in all directions. Red mulch is not acceptable. CYPRESS MULCH WILL NOT BE USED.
3. All trees to be staked in good workmanlike manner. No nail staking permitted. (Refer to planting details)
4. Landscape contractor is responsible for removing trees stakes once trees are established.
5. All tree holes to be back filled around and under root ball with planting soil. All shrub beds to be installed with planing soil (see planting details).
6. Sod shall be as specified in the landscape plan. Solid sod shall be laid with alternative and abutting joints, with 2" top soil minimum if required.
7. All trees and palms are to be guaranteed for one year. All shrubs and ground covers shall be guaranteed for six months from date of final acceptance.
8. All planting beds shall be free of weeds, grass, litter, and construction debris prior to planting.
9. All trees, palms, shrubs, and groundcover plants shall be fertilized at installation with slow release fertilizer, according to manufacturer's recommendations (submit sample for approval).
10. Landscape contractor shall review all drawings and prepare his own take off and plant list prior to bid cost, and compare to Landscape Architect's plant list. Sizes specified on Landscape plan are deemed to be minimums. Landscape Contractor is responsible for attaining accurate counts of plant materials specified. In the event of discrepancies, Landscape Contractor shall bring to the attention of the Landscape Architect. Plan shall take precedence over plant list. No Exceptions!
11. Landscape Contractor shall locate and verify all underground utility prior to digging. Plantings in Easements: Utility, power, or drainage easements may overlap required buffers; however no required trees or shrubs may be located in any utility, power, or street easement or right-of-way.
12. All trees, except street trees, shall be a minimum of twelve (12) feet high and have a minimum dbh of two (2) inches at time of planting except that thirty (30) percent of the tree requirement may be met by native species with a minimum height of eight (8) feet and a minimum dbh of one and one-half (1½) inches at time of planting. Street trees shall have a clear trunk of four (4) feet, an overall height of fifteen (15) feet and a minimum dbh of three (3) inches at time of planting, and shall be provided along all roadways at a maximum average spacing of thirty (30) feet on center.
13. All shrubs must be a minimum of 18" in height at time of planting. When used as a visual screen, buffer, or hedge, shrubs shall be planted at a maximum average spacing of thirty (30) inches on center or if planted at a minimum height of thirty-six (36) inches, shall have a maximum average spacing of forty-eight (48) inches on center and shall be maintained so as to form a continuous, unbroken and solid visual screen within one (1) year after time of planting.
14. All material is subject to availability at time of installation. Substitutions MUST be cleared with Landscape Architect prior to install.
15. All newly planted areas to receive 100% coverage (with 50% overlap) by automatic irrigation system (refer to irrigation plan).
16. All existing plant material to remain shall be protected (see planting details).
17. All trees to be relocated will get root pruned a minimum of 30 days prior to relocation (more if req. by species). Upon relocation, thin out (under LA direction) 25% of tree canopy.
18. After removal/relocation of existing trees and palms, backfill tree pit with planting soil and sod disturbed area (if needed) to bring them to the same level of the surrounding areas.
19. No changes shall be made without the prior consent of the Landscape Architect and Owner.

TREE PROTECTION DURING CONSTRUCTION NOTES

Trees shall be protected during construction activity as determined by the building department through the use of protective barriers in accordance with the Landscape Manual. Trees that are to remain shall be clearly identified with tags. A protected area with a radius of ten feet shall be maintained around trees to remain in accordance with the Landscape Manual, unless a certified arborist otherwise determines in writing that a smaller or larger protected area is acceptable for each tree, or unless existing conditions such as (but not limited to) sidewalks, roads, curbs, fences, railing, etc. that limit the distance a protection barrier can be installed away from the trunk of the tree. If the location of the barrier is less than the desired distance due to existing conditions, then all efforts to strengthen the barrier and highlight its location are to be made so that no harm to the existing tree occurs during construction.

During demolition and/or development or construction, including installation of irrigation systems or any other underground installations, protective barriers shall be placed around each tree and shall remain in order to prevent the destruction or damaging of roots, stems or crowns of such trees. The barriers shall remain in place and intact until approved landscape operations begin; however, barriers may be removed temporarily to accommodate construction needs, provided that the manner and purpose for such temporary removal will not harm the trees. The trees shall be properly irrigated throughout the building process. Trees damaged during construction shall be subject to the provisions of local codes.

TREE MAINTENANCE NOTES

1. Begin maintenance immediately after planting. Maintain all plant material until final acceptance and for a maintenance and warranty period of twelve (12) months after final acceptance.
2. Maintenance shall include but is not limited to pruning, cultivating, mowing, weeding, fertilizing, watering, and application of appropriate pesticides necessary to maintain plants in healthy condition.
 - 1) Reset settled plants to proper grade and position.
 - 2) Restore soil berm and mulch layer.
 - 3) Tighten and repair elastic guys or other supports
 - 4) Correct defective work.
 - 5) Remove and replace rejected material within one (1) working day from notification.
 - 6) Maintain mulch surface weed-free.
3. The contractor is entirely responsible for the irrigation through final acceptance and twelve- (12) month warranty period. Plant material shall receive water in accordance with the water schedule established per Irrigation Notes.

LANDSCAPE CALCULATIONS

Zoning District: **RS-4**
Net Lot Area: **0.176** acres **7,650** square feet

OPEN SPACE

A. Square feet of open space as indicated on site plan:

REQUIRED
2,915 s.f.

PROVIDED
3,063 s.f.

LAWN AREA CALCULATION

A. Maximum lawn area permitted = **50** % x **3,063** square feet

1,532 s.f.

1,529 s.f.

TREES

- A. # trees required per lot (5 for 1st 6,000 s.f. + 1 for each add. 1,000 s.f.) less the existing number of trees that meet minimum requirements
Total lot trees required/provided **7** - existing trees **2** = **5** trees
- B. Percentage of native trees required (trees per lot **5**) x 30% = **2** trees
- C. Drought and salt tolerant required (trees per lot **5**) x 50% = **3** trees
- D. Street trees (max. avg. spacing of 20' o.c.): **50** feet along street + 20 = **3** trees
- E. Total number of trees Required = **8** trees

7 trees per lot
2 existing trees
5 trees
5 trees
5 trees
3 trees
8 trees

SHRUBS

- A. The total number of trees required x 12 = **96** shrubs
- B. The number of shrubs required x 50% native = **48** shrubs

331 shrubs
126 shrubs

LARGE SHRUBS OR SMALL TREES

- A. The total number of shrubs required x 10% = **10** shrubs
- B. The number of large shrubs required x 50% native = **5** shrubs

12 shrubs
12 shrubs

| LANDSCAPE LEGEND | | | | | | |
|------------------|---------------|--|-------|------------------|----------------|---------|
| TAG | NATIVE YES/NO | COMMON NAME / LATIN NAME | QTY | SIZE DBH | INSTALL HEIGHT | SPACING |
| STREET TREES | | | | | | |
| COES | YES | SILVER BUTTWOOD COCNOCARPUS ERECTUS VAR. SERICEUS | 3 | 2" | 12' | N/A |
| SITE TREES | | | | | | |
| | YES | LIVE OAK QUERCUS VIRGINIANA | 1 | EXISTING TREE #3 | | N/A |
| | YES | BLACK OLIVE BUCIDA BUCERAS | 1 | EXISTING TREE #5 | | N/A |
| QUVI | YES | LIVE OAK QUERCUS VIRGINIANA | 1 | 4" | 18' | N/A |
| COUV | YES | SEAGRAPE COCOLOBIA UVIFERA | 2 | 4" | 16' | N/A |
| COER | YES | GREEN BUTTWOOD COCNOCARPUS ERECTUS | 2 | 2" | 12' | N/A |
| LARGE SHRUBS | | | | | | |
| BYLU | YES | LOCUST BERRY BURSONIMA LUCIDA | 6 | 15 gal | 72" | 48" OC |
| CACY | YES | JAMAICA CAPER CAPPARIS CYNOPHALLOPHORA | 6 | 15 gal | 72" | 48" OC |
| SHRUBS | | | | | | |
| TRFL | YES | DWARF FAKAHATCHEE GRASS TRIPSACUM FLORIDANA | 126 | 1 gal | 18" | 18" OC |
| CLGU | NO | SMALL LEAF CLUSIA CLUSIA GUTTIFERA | 22 | 3 gal | 18"-24" | 30" OC |
| FIGI | NO | GREEN ISLAND FIGUS FICUS GREEN ISLAND | 68 | 3 gal | 18" | 24" OC |
| STRE | NO | BIRD OF PARADISE STRELITZIA REGINAE | 4 | 7 gal | 36"-48" | N/A |
| RHEX | NO | LADY PALM RHAPIS EXCELSA | 1 | 15 gal | 48" | N/A |
| DIDE | NO | DIFFENBACHIA (WHITE & GREEN) DIEFFENBACHIA DELULAH | 3 | 3 gal | 24" | N/A |
| ZAZA | NO | ZZ PLANT ZAMIOCULCAS ZAMIIFOLIA | 2 | 3 gal | 24" | N/A |
| BATG | NO | SLENDER WEAVERS BAMBOO BAMBUSA TEXTILUS GRACILIS | 50 | 45 gal | 72" | 36" OC |
| ANAN | NO | ANTHURIUM (MIX OF PINK & RED) ANTHURIUM ANDRAEANUM | 12 | 1 gal | 12" | N/A |
| LMBB | NO | LIRIOPE LIRIOPE MUSCARI 'BIG BLUE' | 14 | 1 gal | 12" | 15" OC |
| TRAT | NO | ASIATIC JASMINE TRICOLOR TRACHELOSPERMUM ASIATICUM 'TRICOLOR' | 30 | 1 gal | 12" | 18" OC |
| MISCELLANEOUS | | | | | | |
| SOD | NO | SEASHORE PASPALUM PASPALUM VAGINATUM | 1,529 | SOLID SOD | N/A | N/A |



PROJECT:
MANDEL D'AMICO RESIDENCE
199 N Coconut Lane
Miami Beach, FL 33139

DRAWING TITLE:
PROPOSED SITE
LANDSCAPE PLAN

NORTH



SCALE:
1/8" = 1' - 0"

PROJECT NUMBER

DATE:
05-23-2019

07-26-2019

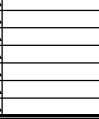

SHEET NUMBER:
LP-1

OF:

4872 S.W. 72nd Avenue
Miami, Florida 33185
(305) 668-3196
Fax: (305) 668-2871

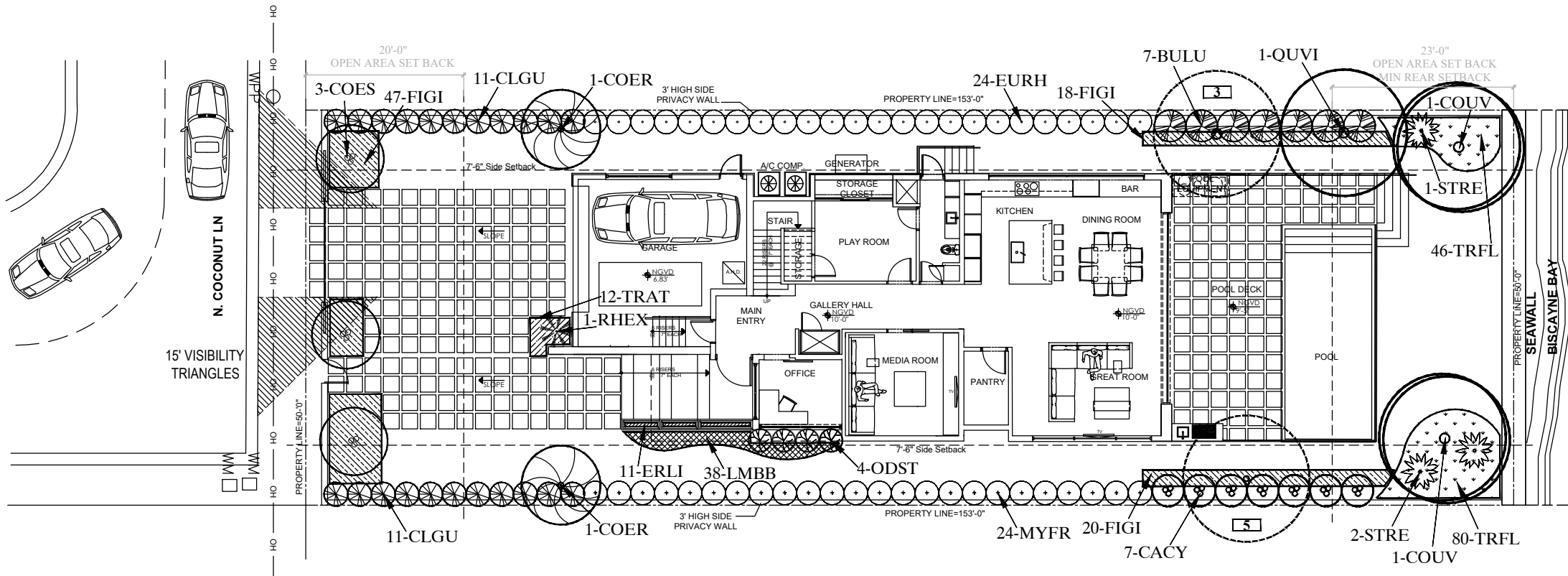

LANDSCAPE NOTES

TREE PROTECTION DURING CONSTRUCTION NOTES

LANDSCAPE CALCULATIONS

| REQUIRED | PROVIDED |
|-------------------------|-------------------|
| <u>2,915</u> s.f. | <u>3,945</u> s.f. |
| <u>1,973</u> s.f. | <u>1,829</u> s.f. |
| <u>7</u> trees per lot | |
| <u>2</u> existing trees | |
| <u>5</u> trees | <u>5</u> trees |
| <u>2</u> trees | <u>5</u> trees |
| <u>3</u> trees | <u>5</u> trees |
| <u>3</u> trees | <u>3</u> trees |
| <u>8</u> trees | <u>8</u> trees |
| <u>96</u> shrubs | <u>292</u> shrubs |
| <u>48</u> shrubs | <u>185</u> shrubs |
| <u>10</u> shrubs | <u>14</u> shrubs |
| <u>5</u> shrubs | <u>14</u> shrubs |

| LANDSCAPE LEGEND | | | | | | | |
|----------------------|---------------|--|-------|------------------|----------------|---------|--|
| TAG | NATIVE YES/NO | COMMON NAME / LATIN NAME | QTY | SIZE DBH | INSTALL HEIGHT | SPACING | |
| STREET TREES | | | | | | | |
| COES | YES | SILVER BUTTONWOOD CONOCARPUS ERECTUS VAR. SERICEUS | 3 | 3" | 14' | N/A | |
| SITE TREES | | | | | | | |
| | YES | LIVE OAK QUERCUS VIRGINIANA | 1 | EXISTING TREE #3 | | N/A | |
| | YES | BLACK OLIVE BUCIDA BUCERAS | 1 | EXISTING TREE #5 | | N/A | |
| QUVI | YES | LIVE OAK QUERCUS VIRGINIANA | 1 | 4" | 18' | N/A | |
| COUV | YES | SEAGRAPE COCOLOBIA UVIFERA | 2 | 4" | 16' | N/A | |
| COER | YES | GREEN BUTTONWOOD CONOCARPUS ERECTUS | 2 | 2" | 12' | N/A | |
| LARGE SHRUBS | | | | | | | |
| BULU | YES | LOCUST BERRY BURSONIMA LUCIDA | 7 | 15 gal | 72" | 48" OC | |
| CACY | YES | JAMAICA CAPER CAPPARIS CYNOPHALLOPHORA | 7 | 15 gal | 72" | 48" OC | |
| SHRUBS | | | | | | | |
| EURH | YES | RED STOPPER EUGENIA RHOMBEA | 24 | 7 gal | 36" | 36" OC | |
| MYFR | YES | SIMPSON'S STOPPER MYRCIANTHES FRAGRANS | 24 | 7 gal | 36" | 36" OC | |
| ERLI | YES | GOLDEN CREEPER ERWODEA UTTORALI | 11 | 1 gal | 12" | 18" OC | |
| TRFL | YES | DWARF FAKAHATCHEE GRASS TRIPSACUM FLORIDANA | 126 | 1 gal | 16" | 18" OC | |
| CLGU | NO | SMALL LEAF CLUSIA CLUSIA GUTTIFERA | 22 | 3 gal | 18"-24" | 30" OC | |
| FIGI | NO | GREEN ISLAND FICUS FICUS GREEN ISLAND | 85 | 3 gal | 16" | 24" OC | |
| STRE | NO | BIRD OF PARADISE STREUTZIA REGINAE | 3 | 7 gal | 36"-48" | N/A | |
| RHEX | NO | LADY PALM RHAPIS EXCELSA | 1 | 15 gal | 48" | N/A | |
| ODST | NO | RED FIRESPIKE ODONTONEMA STRICTUM | 4 | 7 gal | 36" | 36" OC | |
| LMBB | NO | LIRIOPE LIRIOPE MUSCARI 'BIG BLUE' | 38 | 1 gal | 12" | 15" OC | |
| TRAT | NO | ASIATIC JASMINE 'TRICOLOR' TRACHELOSPERMUM ASIATICUM 'TRICOLOR' | 12 | 1 gal | 12" | 18" OC | |
| MISCELLANEOUS | | | | | | | |
| SOD | NO | SEASHORE PASPALUM PASPALUM VAGINATUM | 1,829 | SOLID SOD | N/A | N/A | |

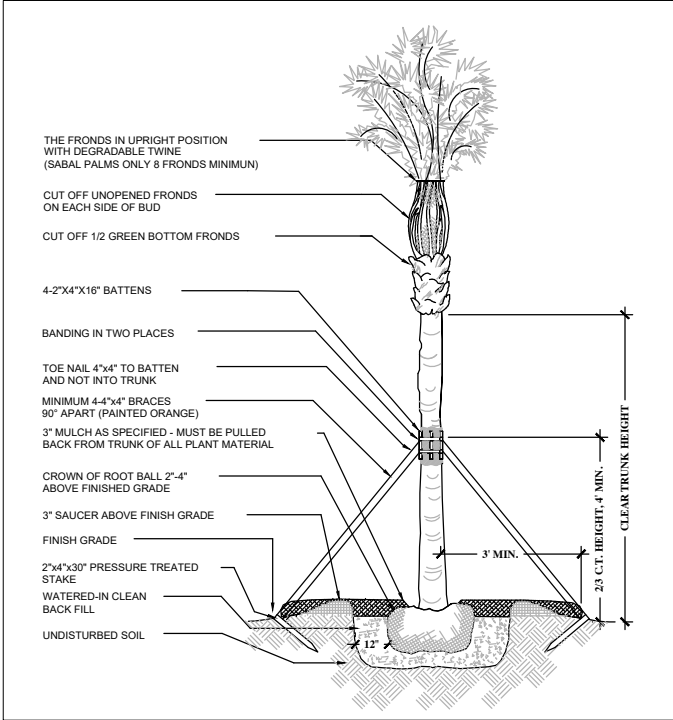

1 Palm Planting Detail
Scale: n.l.s.

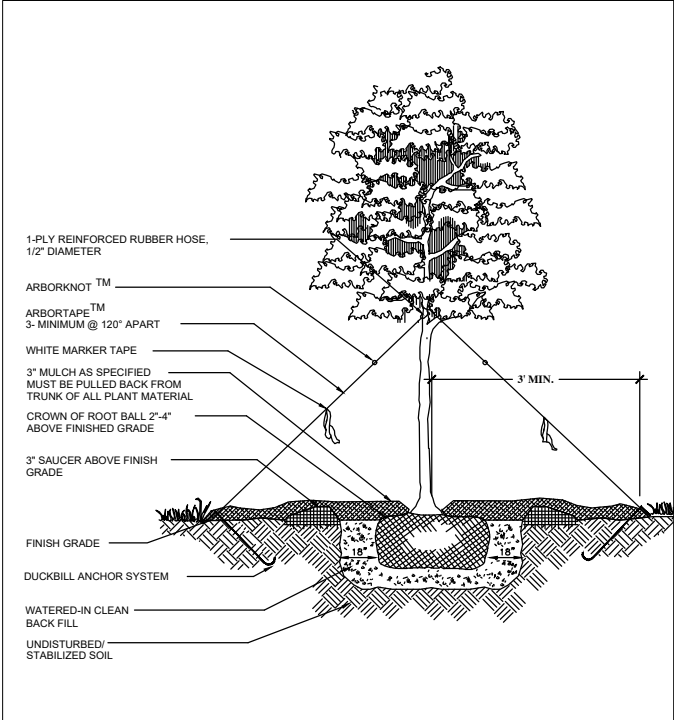

2 Single Trunk Tree Planting Detail
Scale: n.l.s.

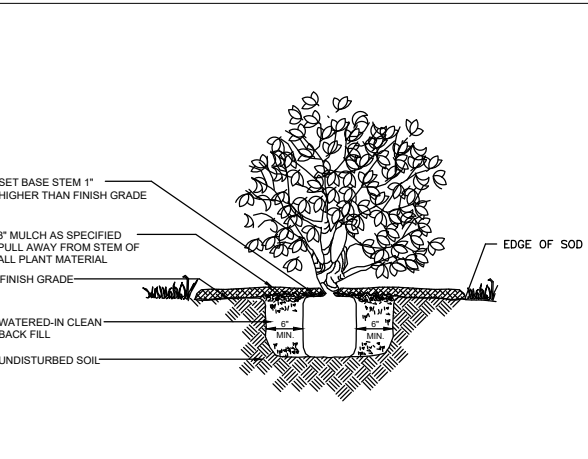

5 Shrub Planting Detail
Scale: n.l.s.

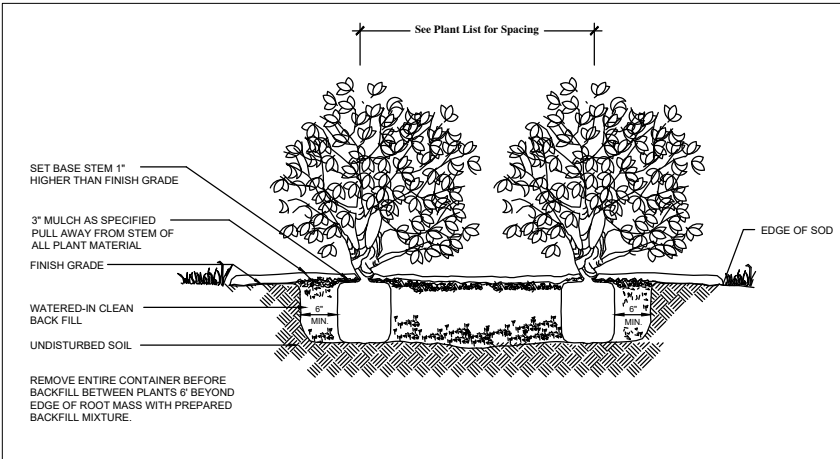

6 Ground Cover Detail
Scale: n.l.s.

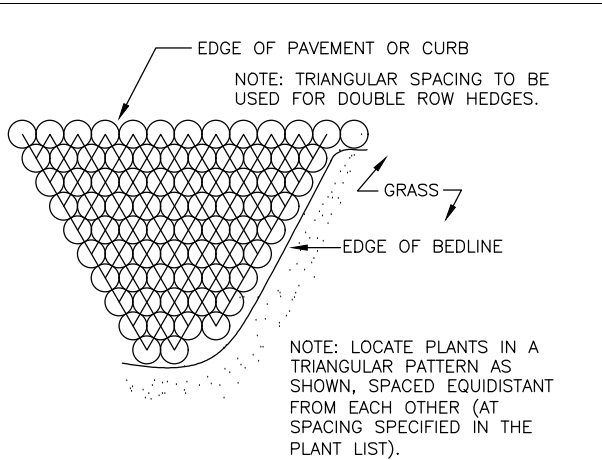

7 Shrub Planting Spacing Detail
Scale: n.l.s.

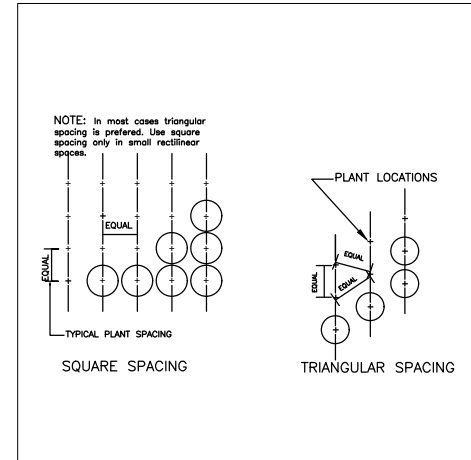

8 Ground Cover Spacing Detail
Scale: n.l.s.

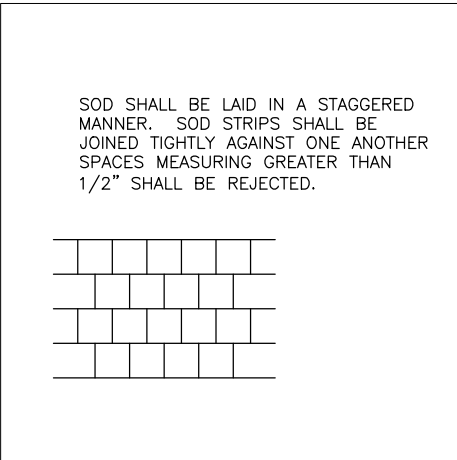

9 Sod Planting Detail
Scale: n.l.s.

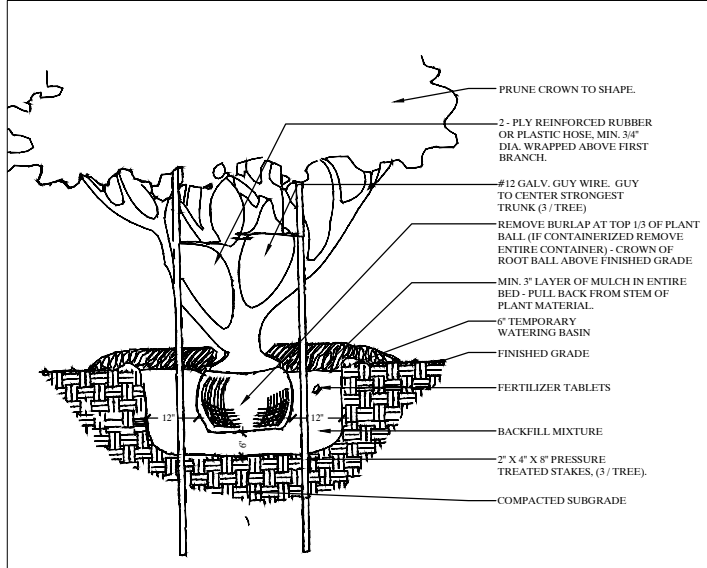

3 Multi-Trunk Tree Planting Detail
Scale: n.l.s.

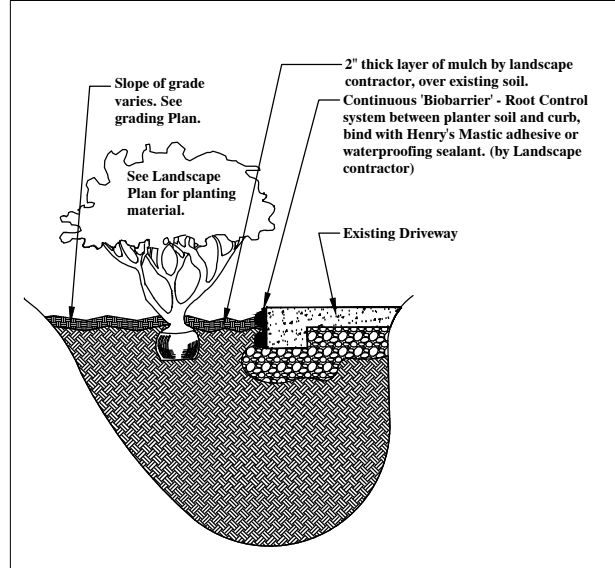

4 Edge of drive Root Barrier
Scale: n.l.s.

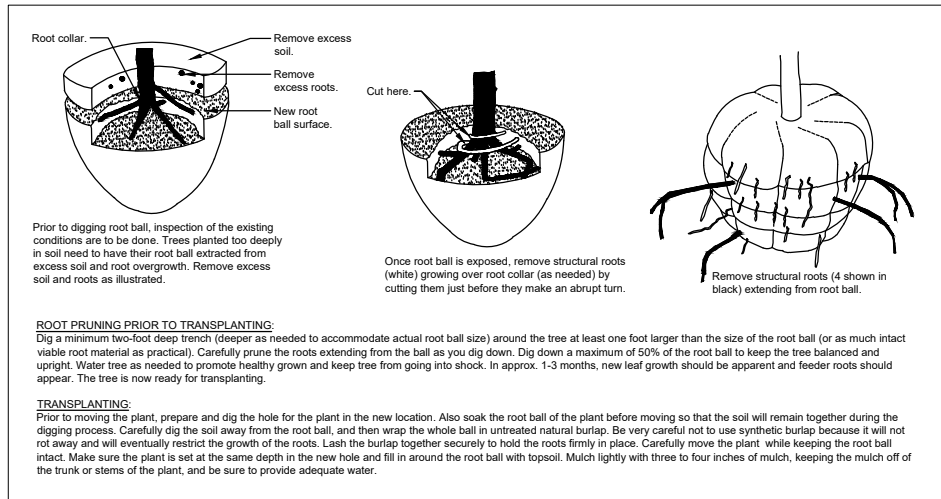

11 Tree Root Prune and Transplant Detail
Scale: N.T.S.

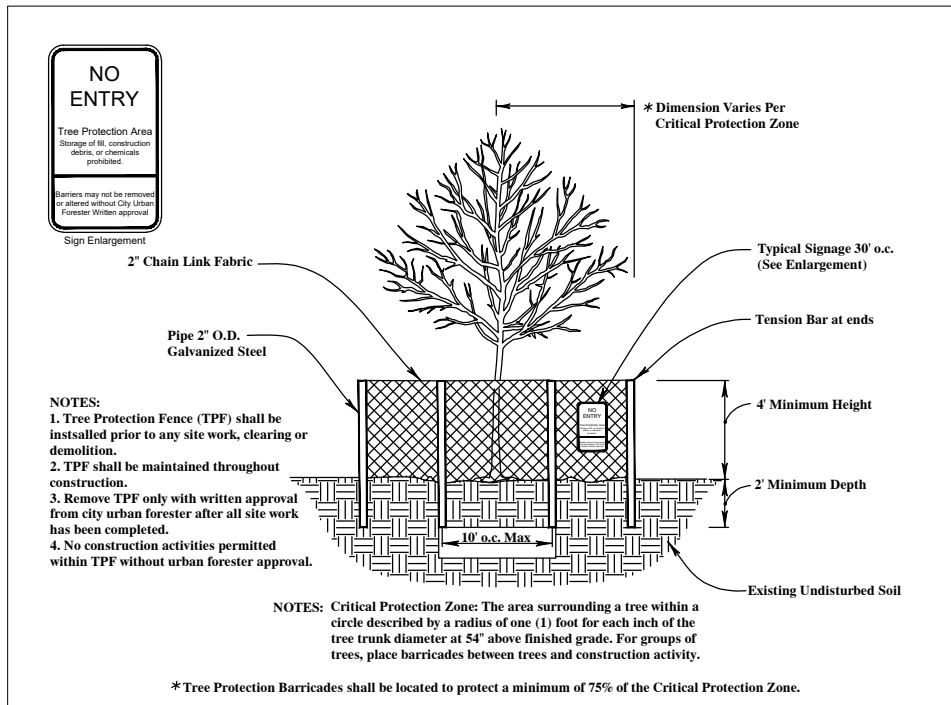

10 Tree Protection Barrier Detail
Scale: 1/2" = 1'-0"

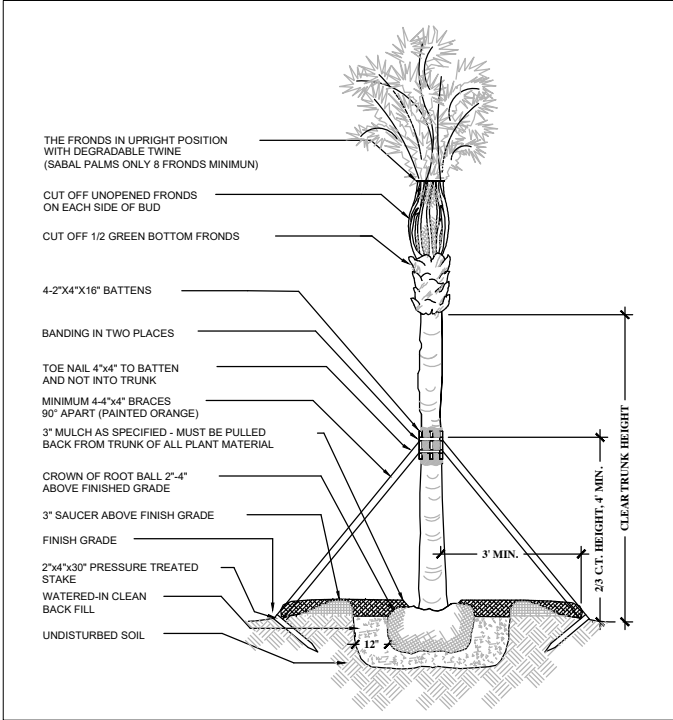

1 Palm Planting Detail

Scale: n.l.s.

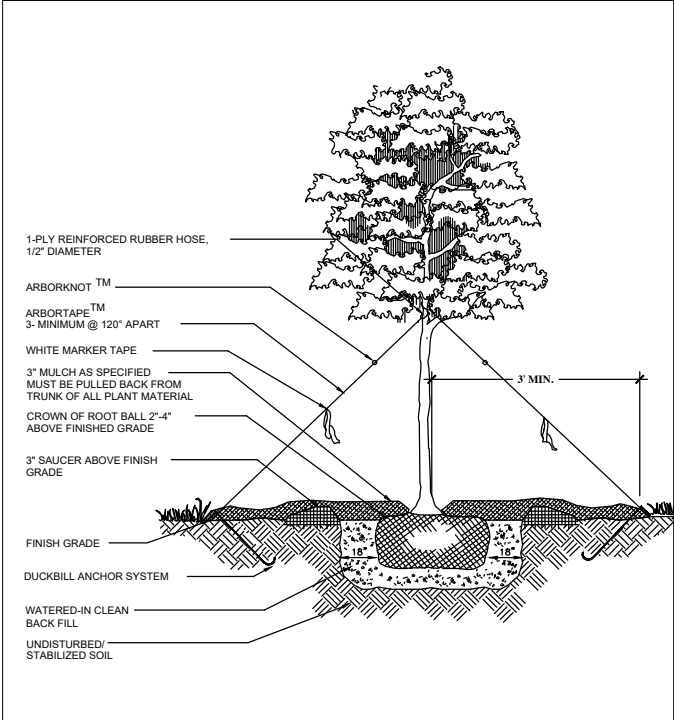

2 Single Trunk Tree Planting Detail

Scale: n.l.s.

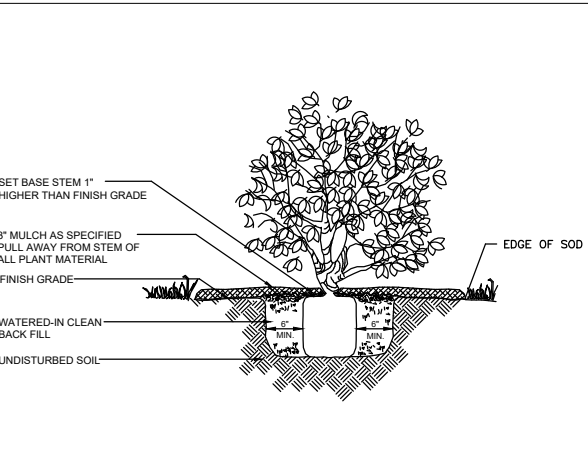

5 Shrub Planting Detail

Scale: n.l.s.

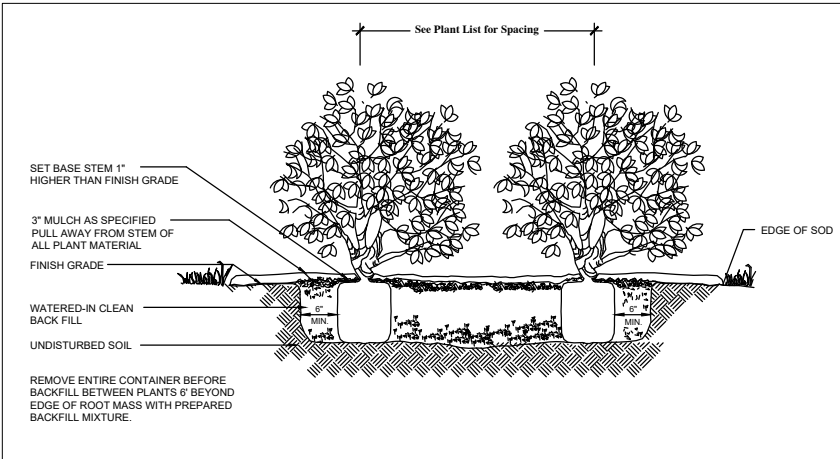

6 Ground Cover Detail

Scale: n.l.s.

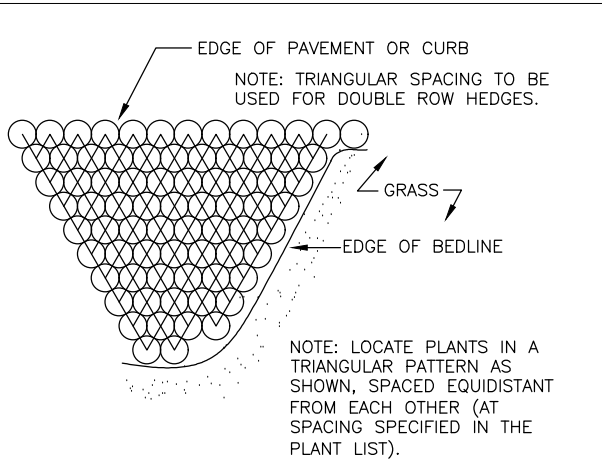

7 Shrub Planting Spacing Detail

Scale: n.l.s.

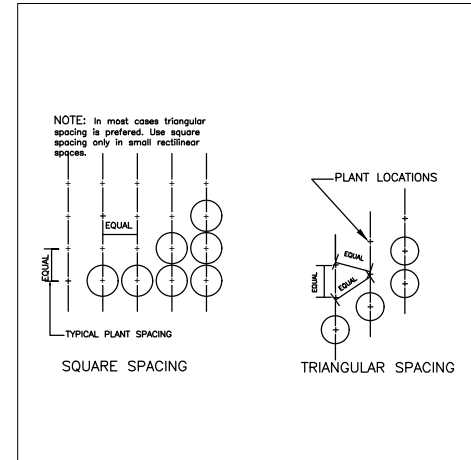

8 Ground CoverSpacing Detail

Scale: n.l.s.

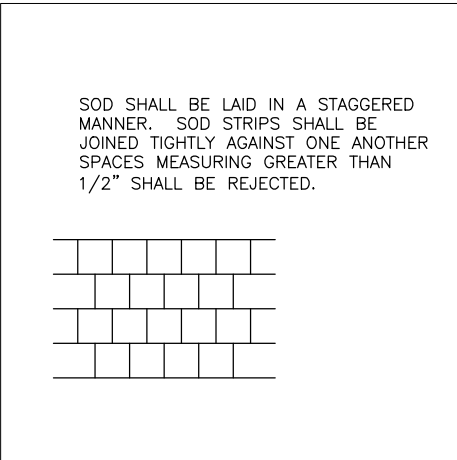

9 Sod Planting Detail

Scale: n.l.s.

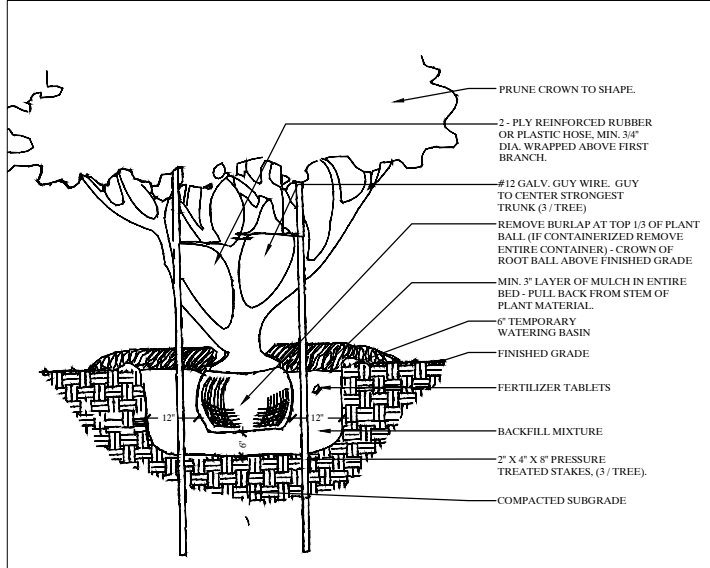

3 Multi-Trunk Tree Planting Detail

Scale: n.l.s.

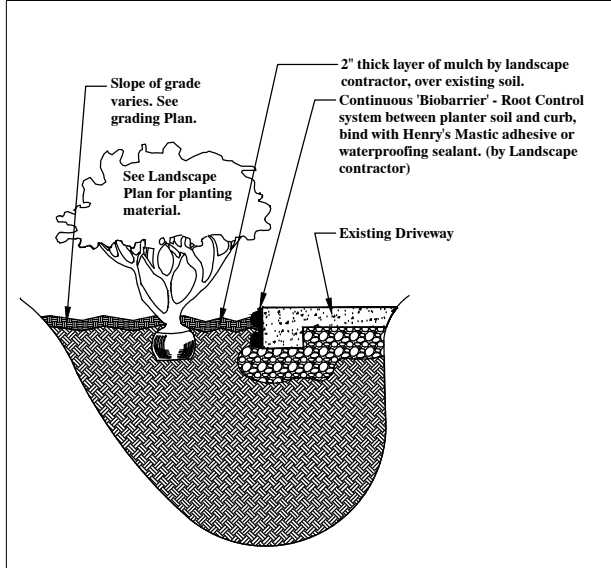

4 Edge of drive Root Barrier

Scale: n.l.s.

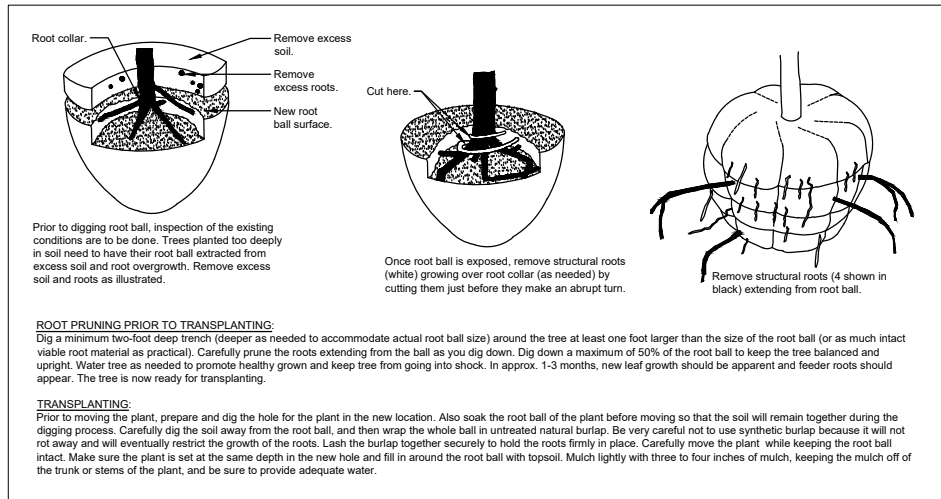

11 Tree Root Prune and Transplant Detail

Scale: N.T.S.

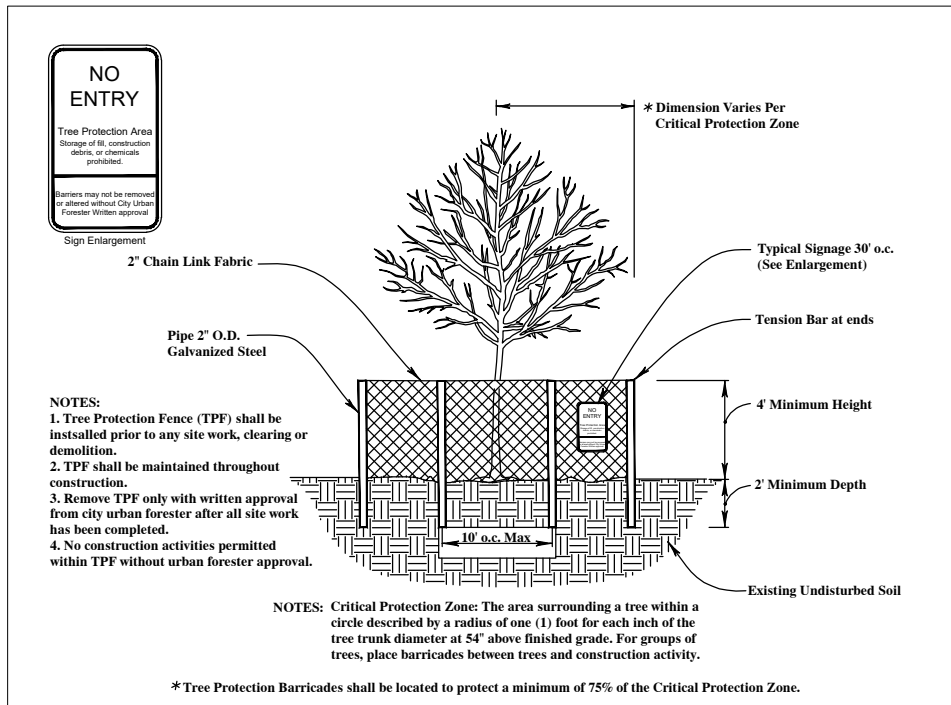

10 Tree Protection Barrier Detail

Scale: 1/2" = 1'-0"



