

LEGEND	
---	PROPERTY LINE
---	ADJOINERS PROPERTY LINE (NOT SURVEYED)
⊞	DRAIN INLET
⊙	LIGHT POLE
⊞	CROSSWALK LIGHT POLE
⊞	TRAFFIC LIGHT POLE
⊞	ELECTRICAL MANHOLE
⊞	WATER MANHOLE
⊞	TELCO MANHOLE
⊞	STORM DRAIN MANHOLE
⊞	SANITARY SEWER MANHOLE
⊞	MANHOLE
○	SIGN
⊞	WATER VALVE
⊞	SPRINKLER
⊞	1/2" IRON REBAR (FOUND)
⊞	PROPERTY CORNER (CALCULATED)

CROWN CASTLE
SMALL WIRELESS FACILITIES
HPB 19-0319 (FL 6449)
2302 Collins Ave.

PROPOSED SITE PLAN
JULY 08, 2019
N.T.S.
R.J. HEISENBOTTLE ARCHITECTS, P.A.
2199 PONCE DE LEON BLV, CORAL GABLES, FLORIDA 33134
PHONE: 305.446.7799 / FAX: 305.446.9275
FLORIDA REGISTRATION NUMBER: AR 0010865



7.30.19

FL6449BA

Aerial View

2302 Collins Ave., Miami Beach, FL 33139



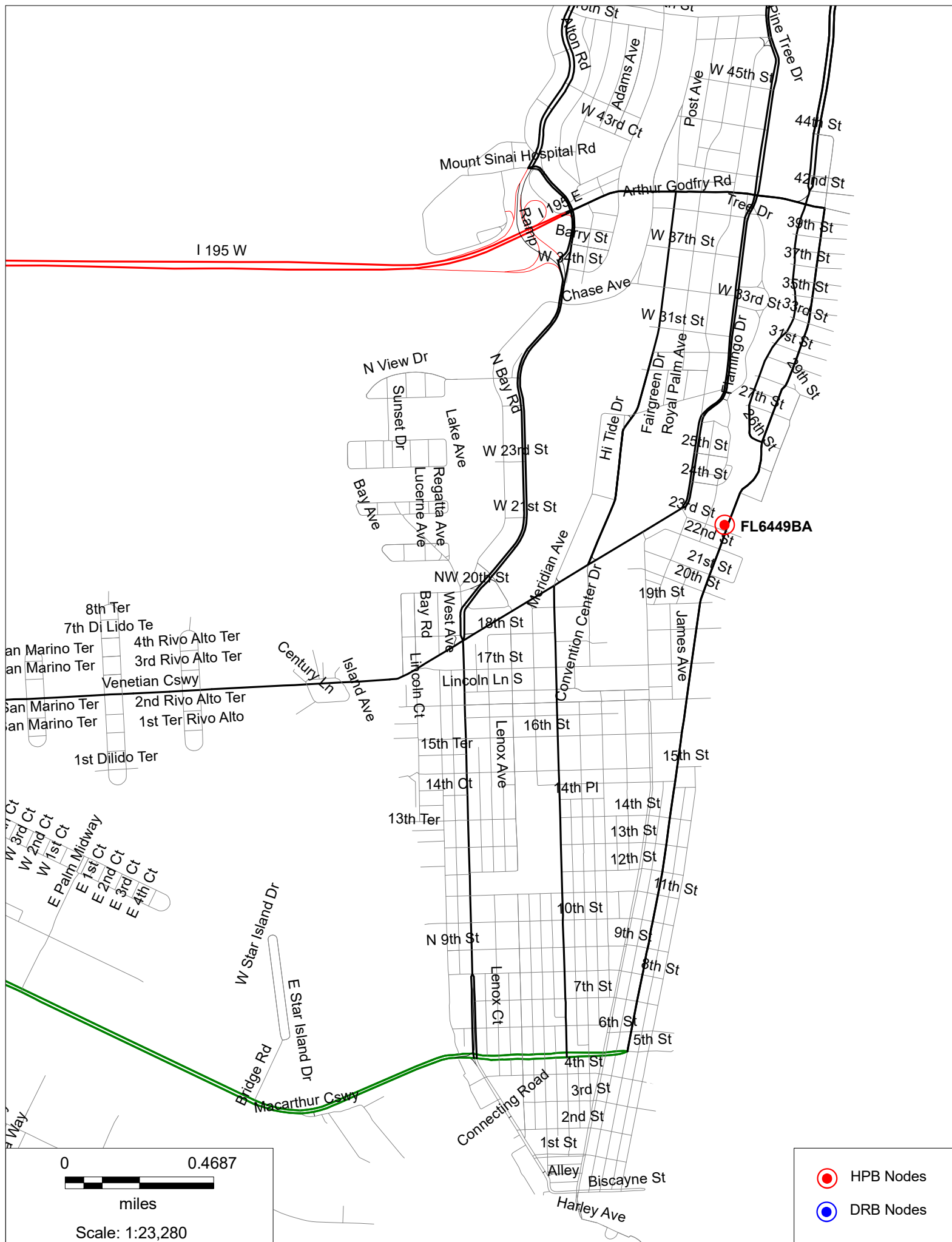





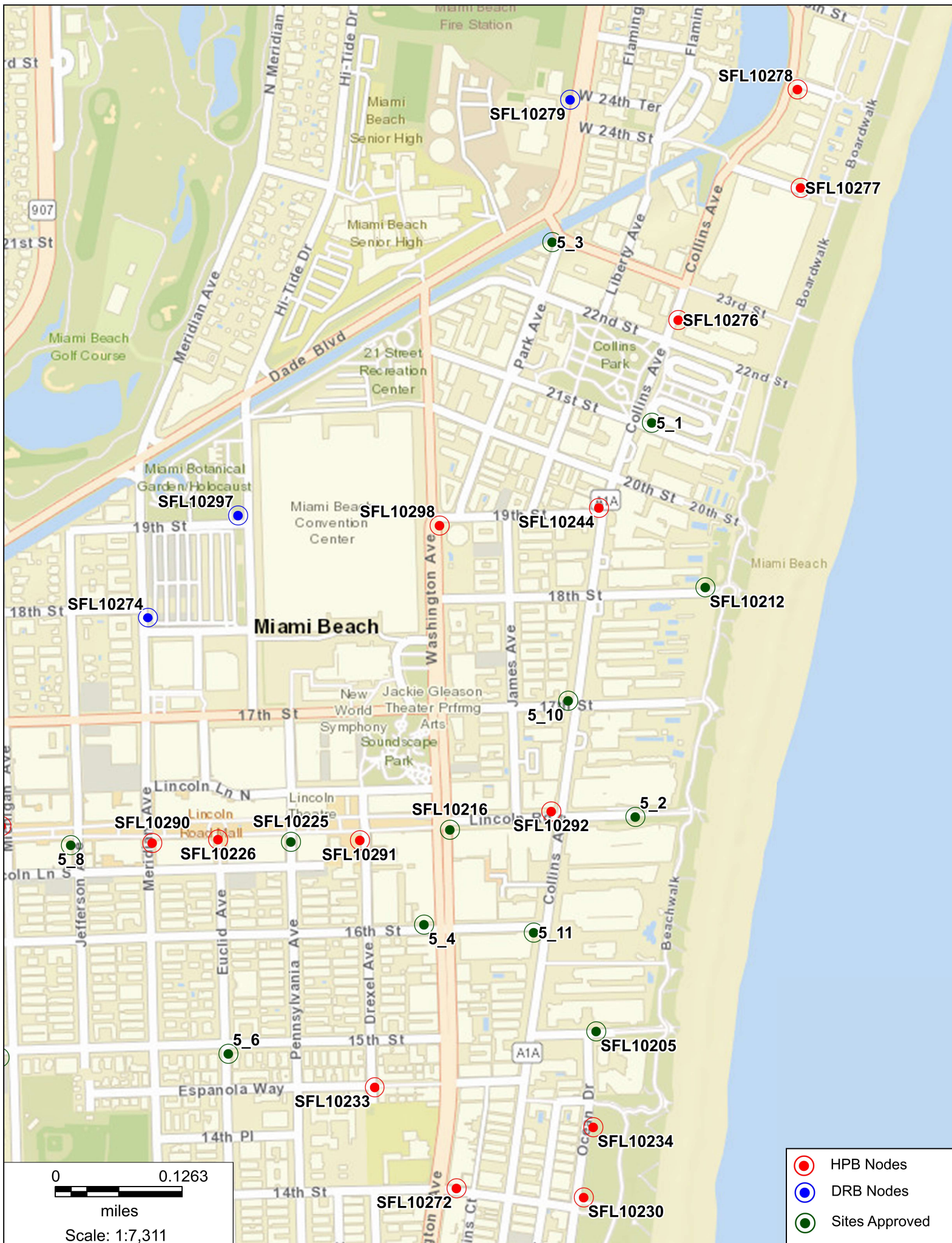

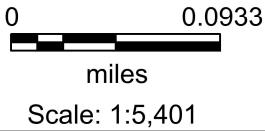

- HPB Nodes
- DRB Nodes
- Sites Approved



FL6449BA

2302 Collins Ave., Miami Beach, FL 33139

Proposed Front view



FL6449BA

2302 Collins Ave., Miami Beach, FL 33139

Proposed Side view



FL6449BA

Aerial View

2302 Collins Ave., Miami Beach, FL 33139



FL6449BA

2302 Collins Ave., Miami Beach, FL 33139

North



FL6449BA

East

2302 Collins Ave., Miami Beach, FL 33139



2302 Collins Ave., Miami Beach, FL 33139



FL6449BA

2302 Collins Ave., Miami Beach, FL 33139

West

