

CITY OF MIAMI BEACH

BAYWALK PEDESTRIAN CONNECTOR BRIDGE

ARCHITECTURE

A5-00	COVER SHEET AND DRAWING INDEX
A5-01A	SURVEY
A5-01B	SURVEY
A5-02	EASEMENTS
A5-03	SITE PLAN
A5-04	BRIDGE REFERENCE
A5-05	IMAGERY
A5-06	RENDERING
A5-08	RENDERING
A5-09	RENDERING
A5-10	RENDERING
A5-11	RENDERING
A5-12	RENDERING
A5-14	RENDERING
A5-15	BRIDGE - LEVEL 1 PLAN
A5-16	BRIDGE - LEVEL 1 SIGNAGE PLAN
A5-17	BRIDGE - LEVEL 2 PLAN
A5-18	BRIDGE - LEVEL 2 SIGNAGE PLAN
A5-19	BRIDGE - ROOF LEVEL RENDERED PLAN
A5-20	BRIDGE - ROOF LEVEL PLAN
A5-21	BRIDGE - LEVEL 1 RCP
A5-22	BRIDGE - WEST AND EAST ELEVATIONS
A5-23	BRIDGE - ELEVATIONS
A5-24	BRIDGE - ELEVATIONS
A5-25	BRIDGE - RENDERED ELEVATIONS
A5-26	BRIDGE - RENDERED ELEVATIONS
A5-27	BRIDGE - RENDERED ELEVATIONS
A5-28	STAIR SECTIONS
A5-29	BRIDGE SECTION
A5-30	PHASE 1 FOUNDATIONS
A5-31	PHASE 2A SUBSTRUCTURE
A5-32	PHASE 2A SUBSTRUCTURE
A5-33	PHASE 2B STAIRS AND ELEVATOR TOWER (LEVEL 1)
A5-34	PHASE 3 BEAM AND ELEVATOR TOWER (LEVEL 2)
A5-35	PHASE 4 STEEL STRUCTURE & GLASS PANELS
A5-36	PHASE 5 FINISH

LANDSCAPE

L0-000	LANDSCAPE INDEX
L0-001	LANDSCAPE NOTES
L0-002	LANDSCAPE CALCULATION
L0-003	PLANT IMAGES
L0-004	HARDSCAPE IMAGES
L0-005	TREE SURVEY
L1-000	TREE DISPOSITION PLAN
L1-001	TREE MITIGATION PLAN
L1-100	GROUND LEVEL RENDERED PLAN
L1-110	GROUND LEVEL HARDSCAPE PLAN
L1-120	GROUND LEVEL TREE PLAN
L1-130	GROUND LEVEL SHRUBS AND GCVR PLAN
L1-140	GROUND LEVEL LIGHTING PLAN
L1-200	2ND LEVEL RENDERED PLAN
L5-110	GROUND LEVEL HARDSCAPE DETAILS
L5-120	GROUND LEVEL PLANTING DETAILS
LIR1-100	GROUND LEVEL IRRIGATION PLAN
LIR5-100	GROUND LEVEL IRRIGATION DETAILS

DRB REVISED SHEETS

ARQUITECTONICA LAKES
ENGINEERING, INC.

2900 Oak Avenue, Miami, FL 33133
T 305.372.1812 F 305.372.1175

No copies, transmissions, reproductions, or electronic manipulation of any portion of these drawings in whole or in part are to be made without the express written permission of Arquitectonica International. All designs indicated in these drawings are property of Arquitectonica International. All copyrights reserved (c) 2019. The data included in this study is conceptual in nature and will continue to be modified throughout the course of the projects development with the eventual integration of structural, MEP and life safety systems. As these are further refined, the numbers will be adjusted accordingly.

BAYWALK
PEDESTRIAN CONNECTOR
BRIDGE

MIAMI BEACH, FL 33139

COVER SHEET AND DRAWING
INDEX

DATE:
07/08/2019

A5-00



ARQUITECTONICA LAKES
ENGINEERING, INC.

2900 Oak Avenue, Miami, FL 33133
T 305.372.1812 F 305.372.1175

No copies, transmissions, reproductions, or electronic manipulation of any portion of these drawings in whole or in part are to be made without the express written permission of Arquitectonica International. All designs indicated in these drawings are property of Arquitectonica International. All copyrights reserved (c) 2019. The data included in this study is conceptual in nature and will continue to be modified throughout the course of the projects development with the eventual integration of structural, MEP and life safety systems. As these are further refined, the numbers will be adjusted accordingly.

BAYWALK
PEDESTRIAN CONNECTOR
BRIDGE

MIAMI BEACH, FL 33139

RENDERING



DATE:
07/08/2019

A5-06



ARQUITECTONICA LAKES
ENGINEERING, INC.

2900 Oak Avenue, Miami, FL 33133
T 305.372.1812 F 305.372.1175

No copies, transmissions, reproductions, or electronic manipulation of any portion of these drawings in whole or in part are to be made without the express written permission of Arquitectonica International. All designs indicated in these drawings are property of Arquitectonica International. All copyrights reserved (c) 2019. The data included in this study is conceptual in nature and will continue to be modified throughout the course of the projects development with the eventual integration of structural, MEP and life safety systems. As these are further refined, the numbers will be adjusted accordingly.

BAYWALK
PEDESTRIAN CONNECTOR
BRIDGE

MIAMI BEACH, FL 33139

RENDERING

Scale:

0 2 4 10 30 60 ft



DATE:
07/08/2019

A5-08



ARQUITECTONICA LAKES
ENGINEERING, INC.

2900 Oak Avenue, Miami, FL 33133
T 305.372.1812 F 305.372.1175

No copies, transmissions, reproductions, or electronic manipulation of any portion of these drawings in whole or in part are to be made without the express written permission of Arquitectonica International. All designs indicated in these drawings are property of Arquitectonica International. All copyrights reserved (c) 2019. The data included in this study is conceptual in nature and will continue to be modified throughout the course of the projects development with the eventual integration of structural, MEP and life safety systems. As these are further refined, the numbers will be adjusted accordingly.

BAYWALK
PEDESTRIAN CONNECTOR
BRIDGE

MIAMI BEACH, FL 33139

RENDERING

Scale:

0 2 4 16 32 64 ft



DATE:
07/08/2019

A5-09

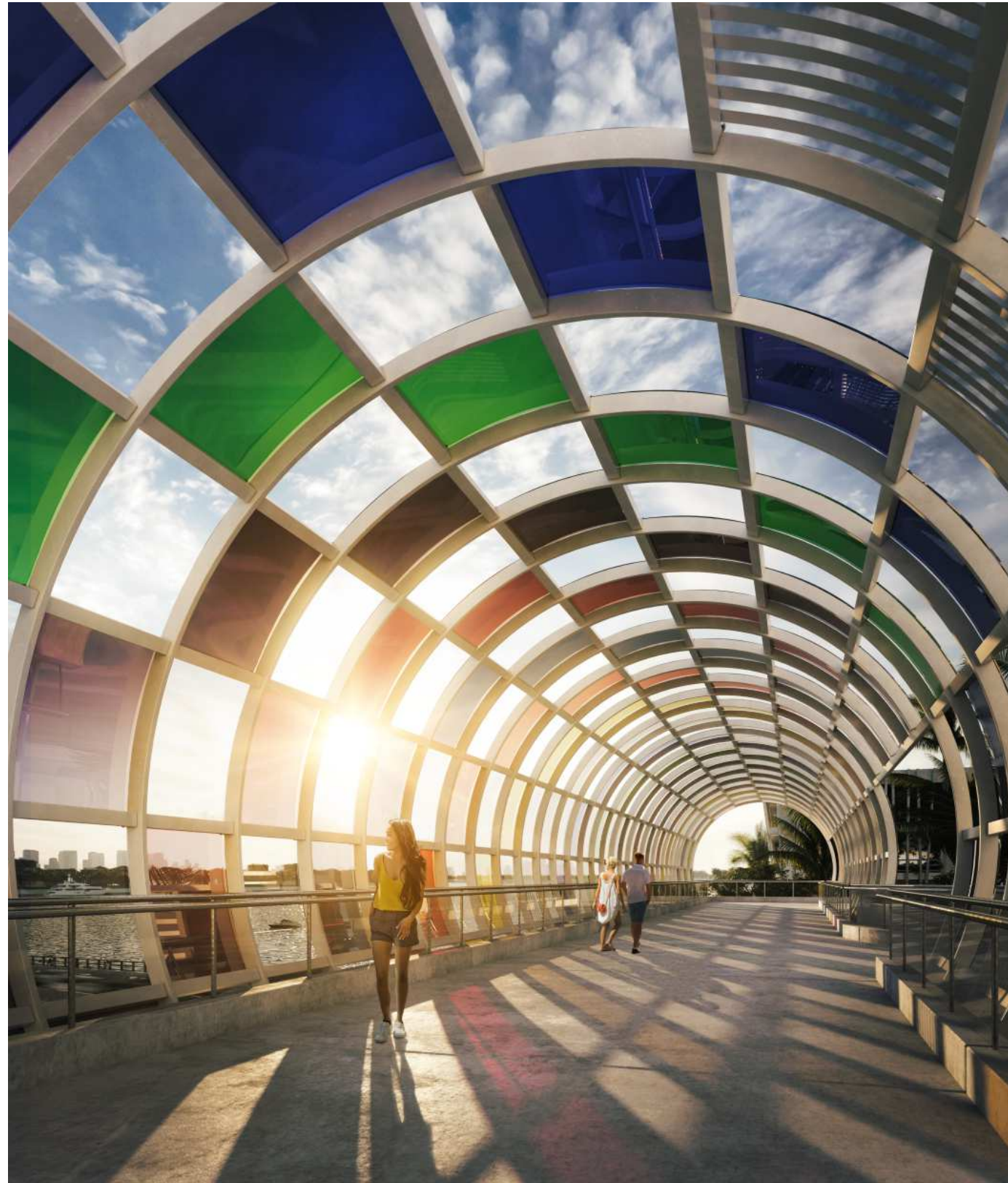

ARQUITECTONICA LAKES
ENGINEERING, INC.

2900 Oak Avenue, Miami, FL 33133
T 305.372.1812 F 305.372.1175

No copies, transmissions, reproductions, or electronic manipulation of any portion of these drawings in whole or in part are to be made without the express written permission of Arquitectonica International. All designs indicated in these drawings are property of Arquitectonica International. All copyrights reserved (c) 2019. The data included in this study is conceptual in nature and will continue to be modified throughout the course of the projects development with the eventual integration of structural, MEP and life safety systems. As these are further refined, the numbers will be adjusted accordingly.

BAYWALK
PEDESTRIAN CONNECTOR
BRIDGE

MIAMI BEACH, FL 33139

RENDERING

Scale:

0 2 4 16 32 64 ft



DATE:
07/08/2019

A5-10



ARQUITECTONICA LAKES
ENGINEERING, INC.

2900 Oak Avenue, Miami, FL 33133
T 305.372.1812 F 305.372.1175

No copies, transmissions, reproductions, or electronic manipulation of any portion of these drawings in whole or in part are to be made without the express written permission of Arquitectonica International. All designs indicated in these drawings are property of Arquitectonica International. All copyrights reserved (c) 2019. The data included in this study is conceptual in nature and will continue to be modified throughout the course of the projects development with the eventual integration of structural, MEP and life safety systems. As these are further refined, the numbers will be adjusted accordingly.

BAYWALK
PEDESTRIAN CONNECTOR
BRIDGE

MIAMI BEACH, FL 33139

RENDERING

Scale:

0 2 4 10 30 60 ft



DATE:
07/08/2019

A5-11



ARQUITECTONICA LAKES
ENGINEERING, INC.

2900 Oak Avenue, Miami, FL 33133
T 305.372.1812 F 305.372.1175

No copies, transmissions, reproductions, or electronic manipulation of any portion of these drawings in whole or in part are to be made without the express written permission of Arquitectonica International. All designs indicated in these drawings are property of Arquitectonica International. All copyrights reserved (c) 2019. The data included in this study is conceptual in nature and will continue to be modified throughout the course of the projects development with the eventual integration of structural, MEP and life safety systems. As these are further refined, the numbers will be adjusted accordingly.

BAYWALK
PEDESTRIAN CONNECTOR
BRIDGE

MIAMI BEACH, FL 33139

RENDERING

Scale:

0 2 4 16 32 64 ft



DATE:
07/08/2019

A5-12



ARQUITECTONICA LAKES
ENGINEERING, INC.

2900 Oak Avenue, Miami, FL 33133
T 305.372.1812 F 305.372.1175

No copies, transmissions, reproductions, or electronic manipulation of any portion of these drawings in whole or in part are to be made without the express written permission of Arquitectonica International. All designs indicated in these drawings are property of Arquitectonica International. All copyrights reserved (c) 2019. The data included in this study is conceptual in nature and will continue to be modified throughout the course of the projects development with the eventual integration of structural, MEP and life safety systems. As these are further refined, the numbers will be adjusted accordingly.

BAYWALK
PEDESTRIAN CONNECTOR
BRIDGE

MIAMI BEACH, FL 33139

RENDERING

Scale:

0 2 4 16 32 64 ft



DATE:
07/08/2019

A5-14