

LEGEND	
LS	EXISTING LANDSCAPE AREA
⊙ WW	EXISTING WATER VALVE
⊙	EXISTING ELECTRICAL HANDHOLE
⊙	EXISTING STREET LIGHT
⊙	EXISTING SIGN
⊙	EXISTING FIRE DEPT. CONNECTION
⊙	EXISTING FIRE HYDRANT
⊙	EXISTING NEWSPAPER BOX
⊙	EXISTING PARKING METER
⊙	EXISTING PAY PHONE
⊙	EXISTING SEWER MANHOLE
⊙	EXISTING TRASH CAN
⊙	EXISTING TREE
⊙	EXISTING PALM TREE

CROWN CASTLE
SMALL WIRELESS FACILITIES
HPB 19-0309 (SFL 10230)
110 14th Street

PROPOSED SITE PLAN
MAY 30, 2019
N.T.S.

R.J. HEISENBOTTLE ARCHITECTS, P.A.
2199 PONCE DE LEON BLV, CORAL GABLES, FLORIDA 33134
PHONE: 305.446.7799 / FAX: 305.446.9275
FLORIDA REGISTRATION NUMBER: AR 0010865

5.29.19



SFL10230

110 14th Street, Miami Beach, FL 33139

Aerial View



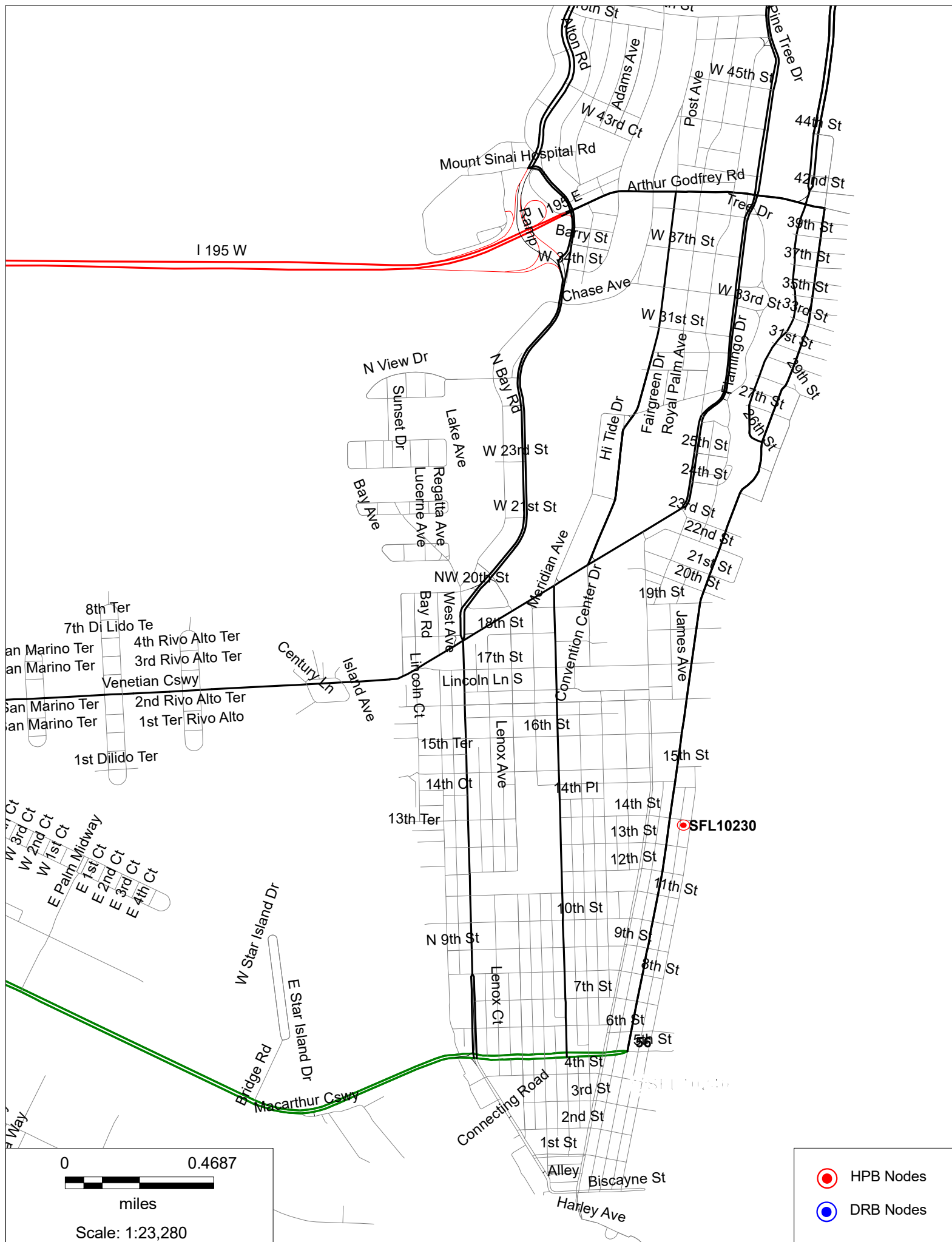







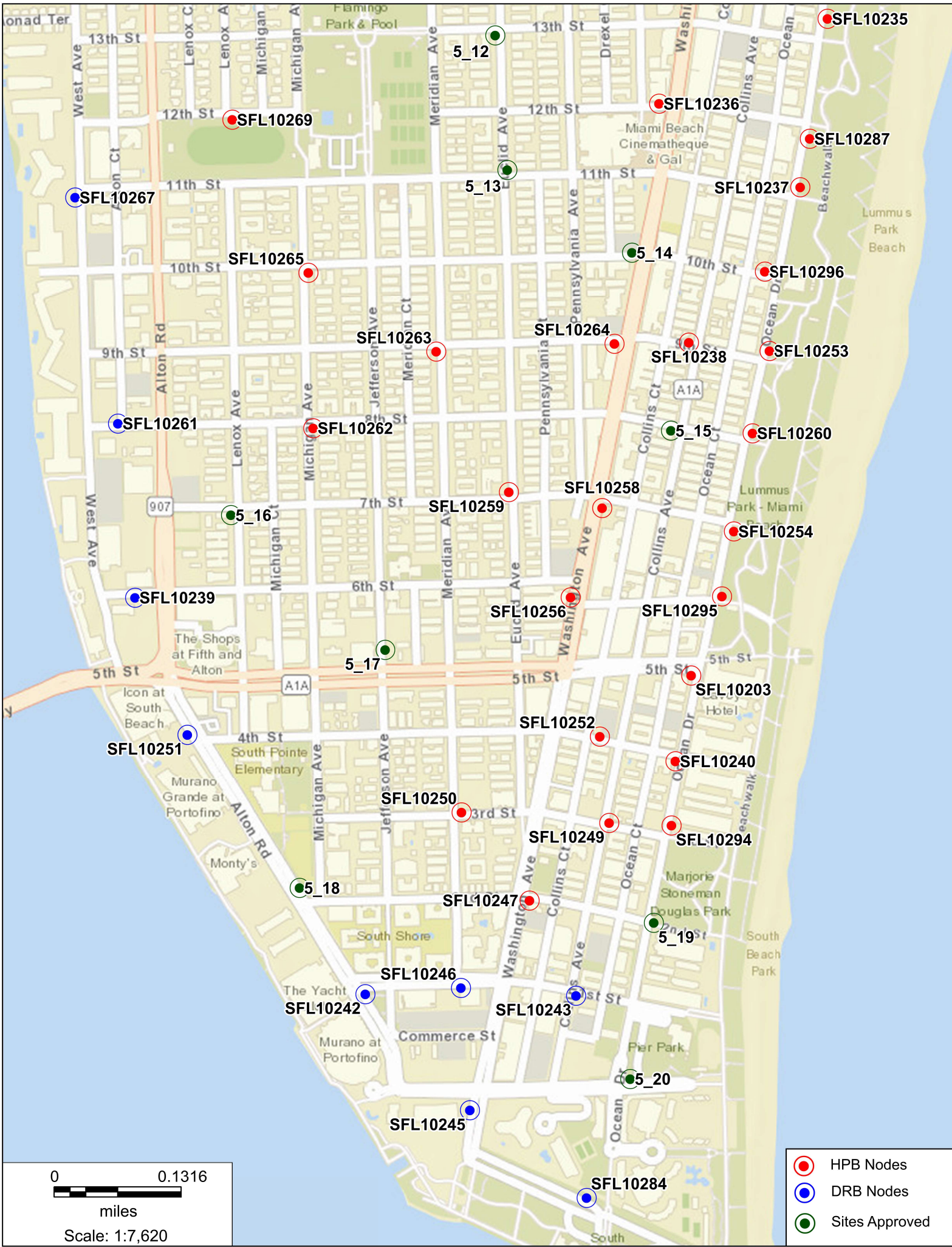

SFL10230

110 14th Street, Miami Beach, FL 33139

Proposed Front view



SFL10230

110 14th Street, Miami Beach, FL 33139

Proposed Side view



SFL10230

110 14th Street, Miami Beach, FL 33139

Aerial View



SFL10230

110 14th Street, Miami Beach, FL 33139

North



SFL10230

110 14th Street, Miami Beach, FL 33139

East



SFL10230

110 14th Street, Miami Beach, FL 33139

South



SFL10230

110 14th Street, Miami Beach, FL 33139

West

