

| LEGEND | |
|--------|------------------------------|
| BOL | EXISTING BOLLARD |
| DMH | EXISTING DRAINAGE MANHOLE |
| DR | EXISTING DRAIN |
| EH | EXISTING ELECTRICAL HANDHOLE |
| EMH | EXISTING ELECTRICAL MANHOLE |
| GL | EXISTING GROUND LIGHT |
| HH | EXISTING HANDHOLE |
| L/S | EXISTING LANDSCAPE AREA |
| MH | EXISTING MANHOLE |
| SMH | EXISTING SEWER MANHOLE |
| SIG | EXISTING SIGN |
| SL | EXISTING STREET LIGHT |
| TRH | EXISTING TRAFFIC HANDHOLE |
| TC | EXISTING TRASH CAN |
| WMB | EXISTING WATER METER BOX |
| PT | EXISTING PALM TREE |

CROWN CASTLE
SMALL WIRELESS FACILITIES
HPB 19-0306 (FL 6455)
1532 Washington Ave.

PROPOSED SITE PLAN
MAY 30, 2019
N.T.S.
R.J. HEISENBOTTLE ARCHITECTS, P.A.
2199 PONCE DE LEON BLV, CORAL GABLES, FLORIDA 33134
PHONE: 305.446.7799 / FAX: 305.446.9275
FLORIDA REGISTRATION NUMBER: AR 0010865

5.29.19
NORTH

FL6455BA

1532 Washington Ave. Miami Beach, FL 33139

Aerial View

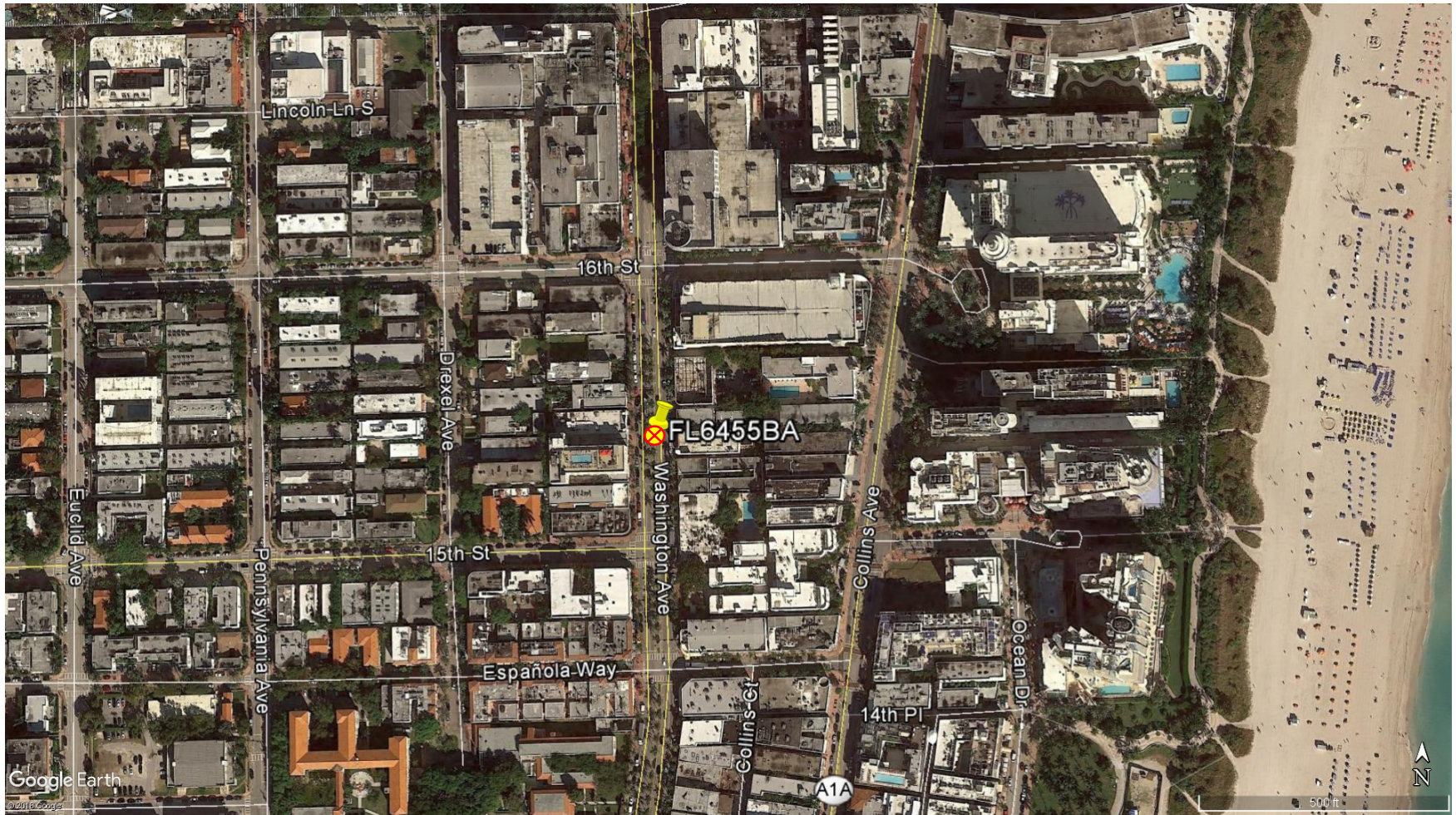

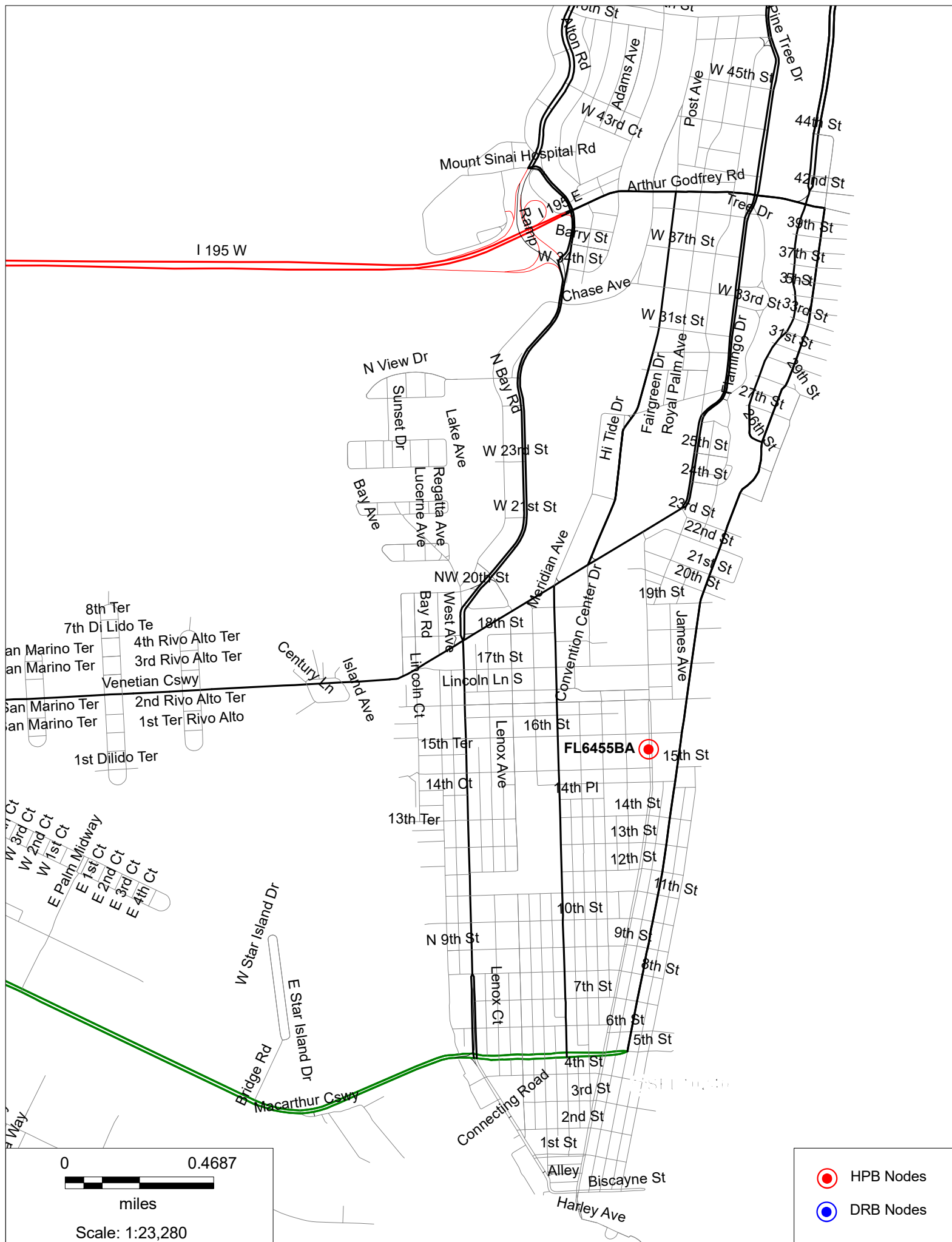



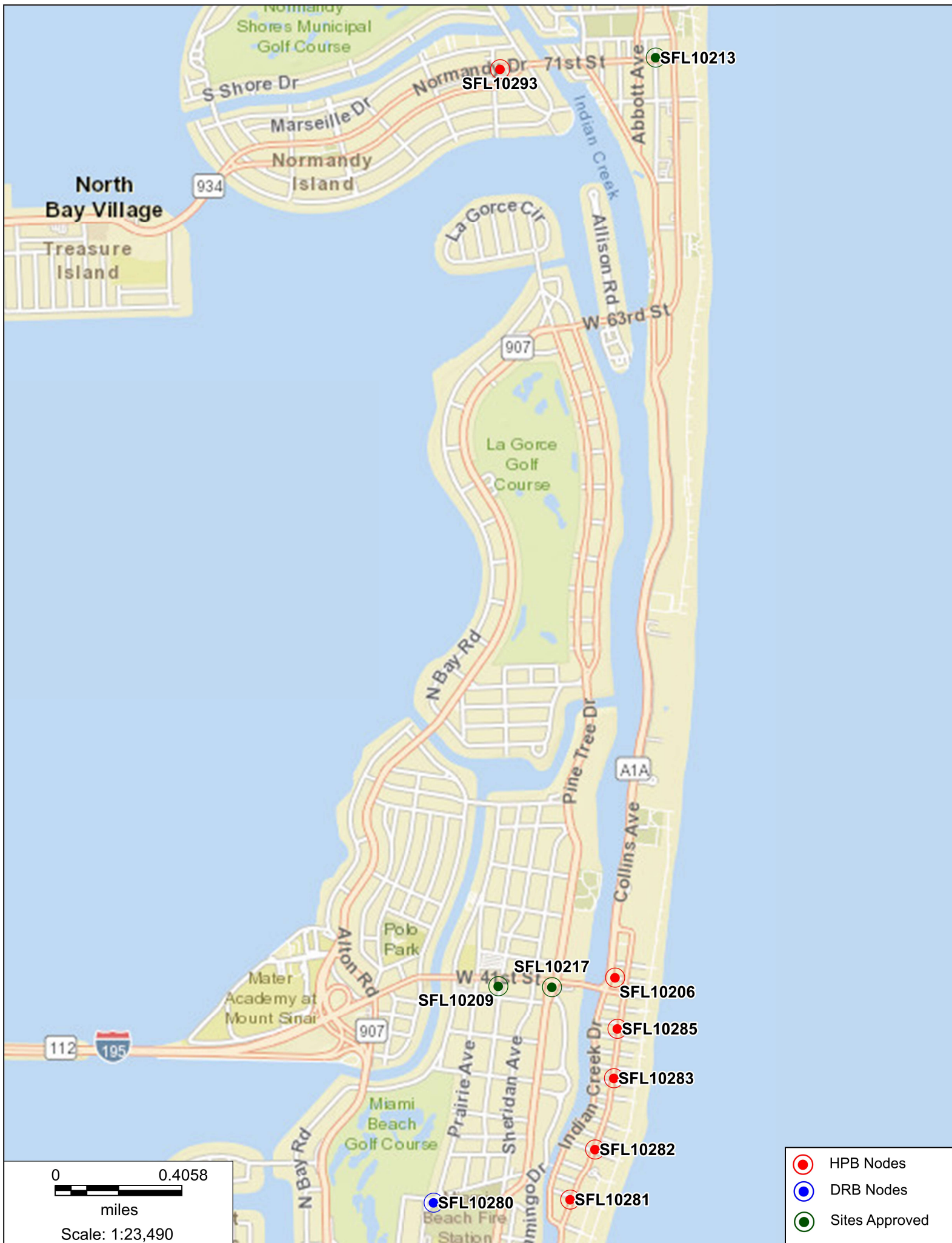

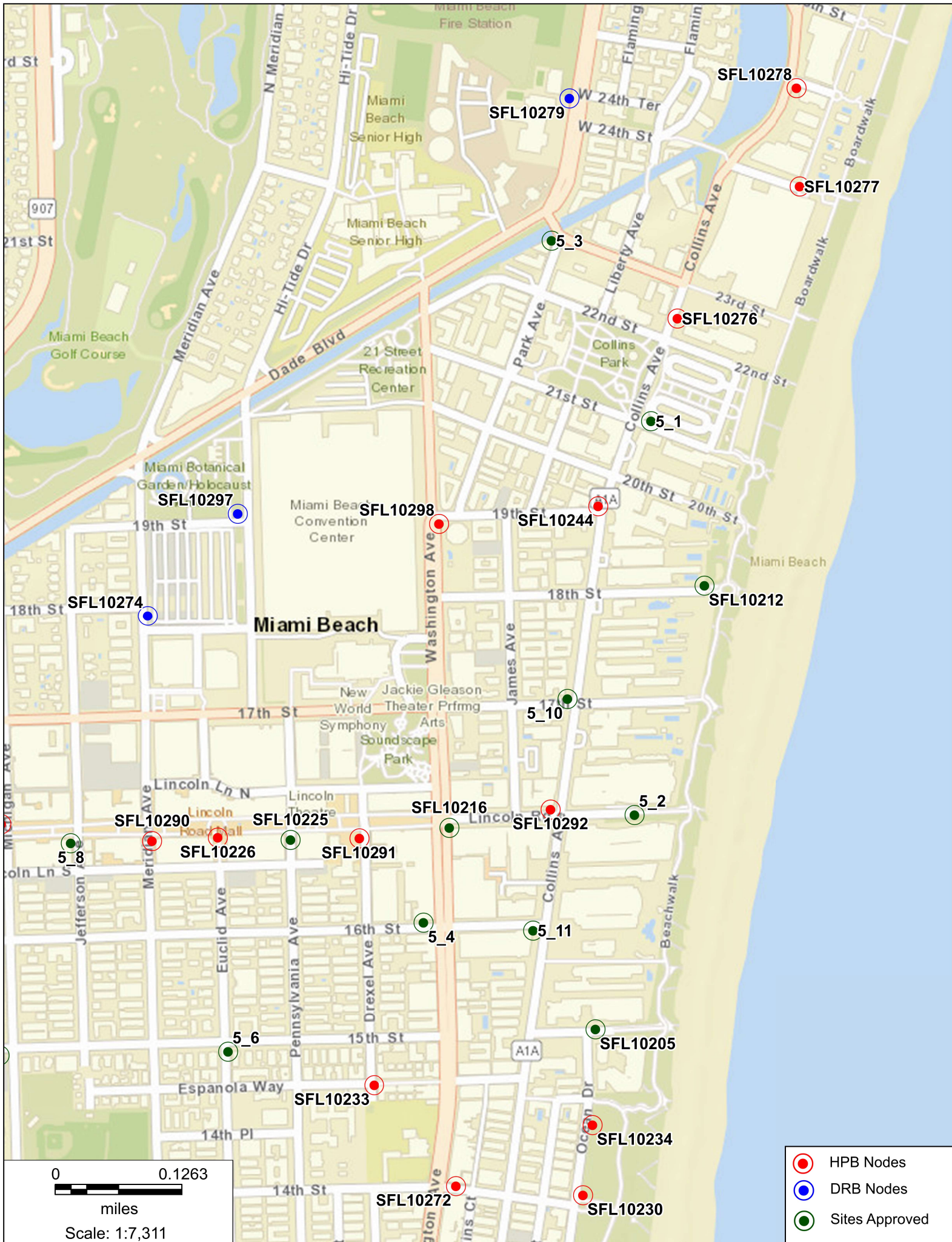

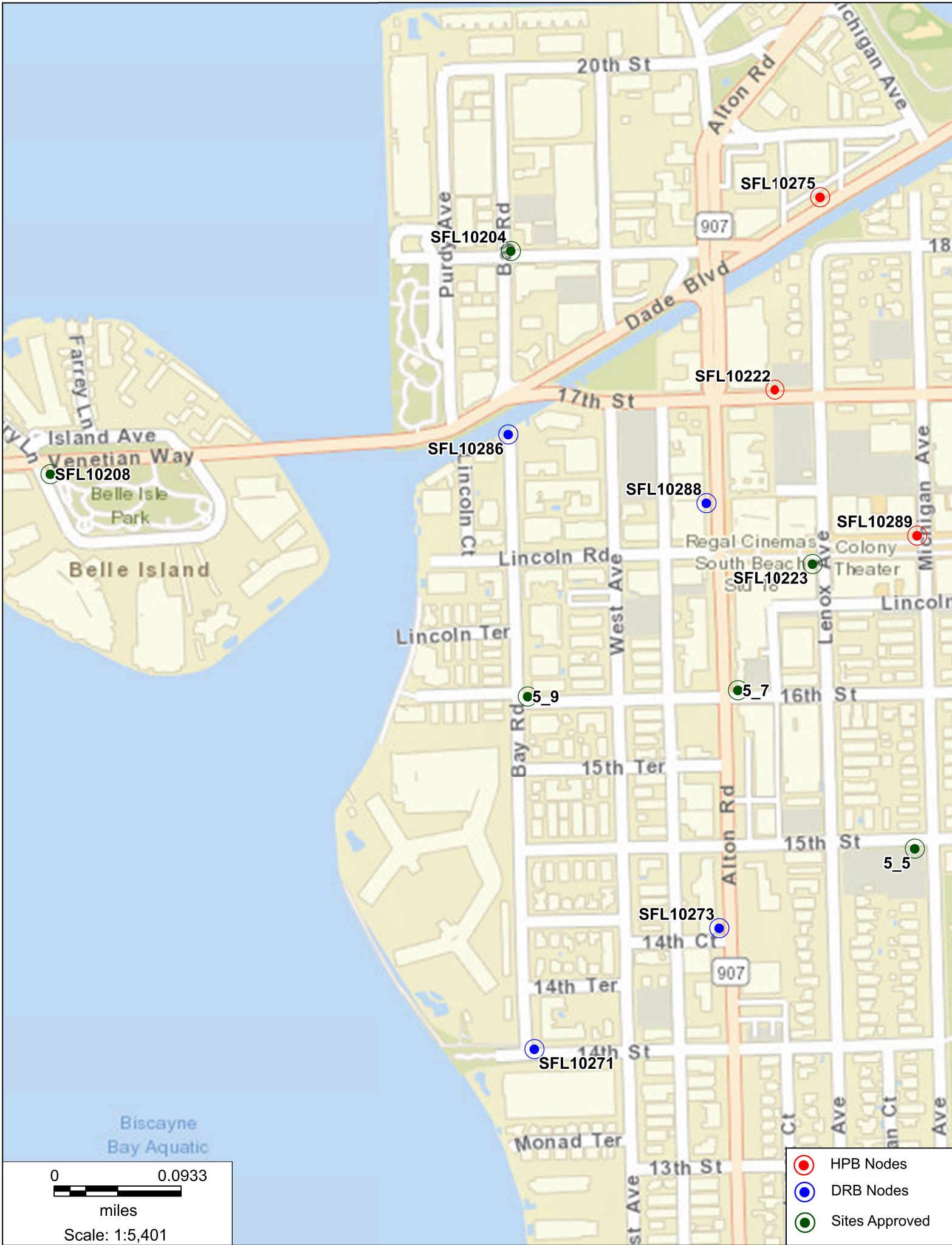

- HPB Nodes
- DRB Nodes
- Sites Approved

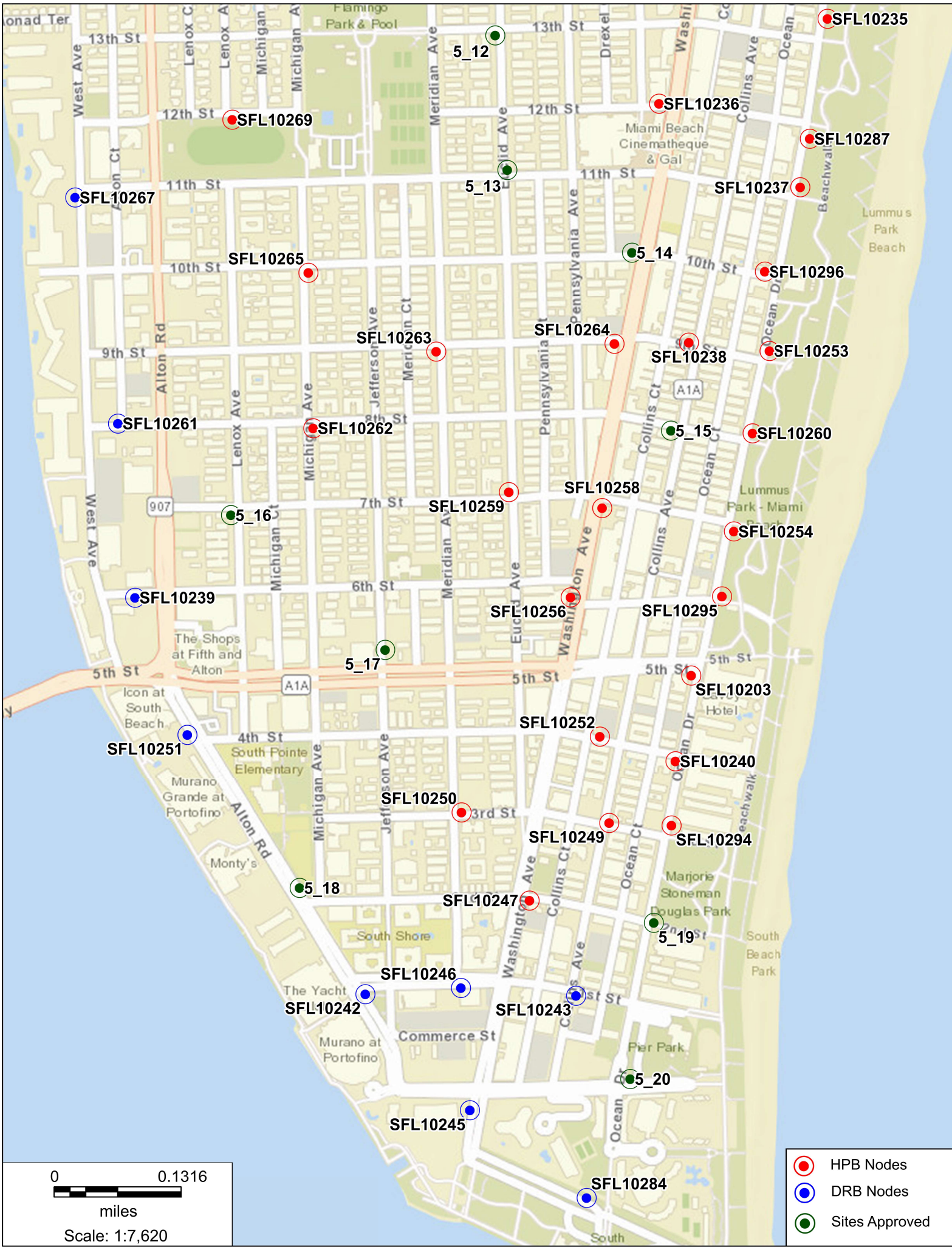



FL6455BA

1532 Washington Ave. Miami Beach, FL 33139

Proposed Side view



FL6455BA

1532 Washington Ave. Miami Beach, FL 33139

Aerial View

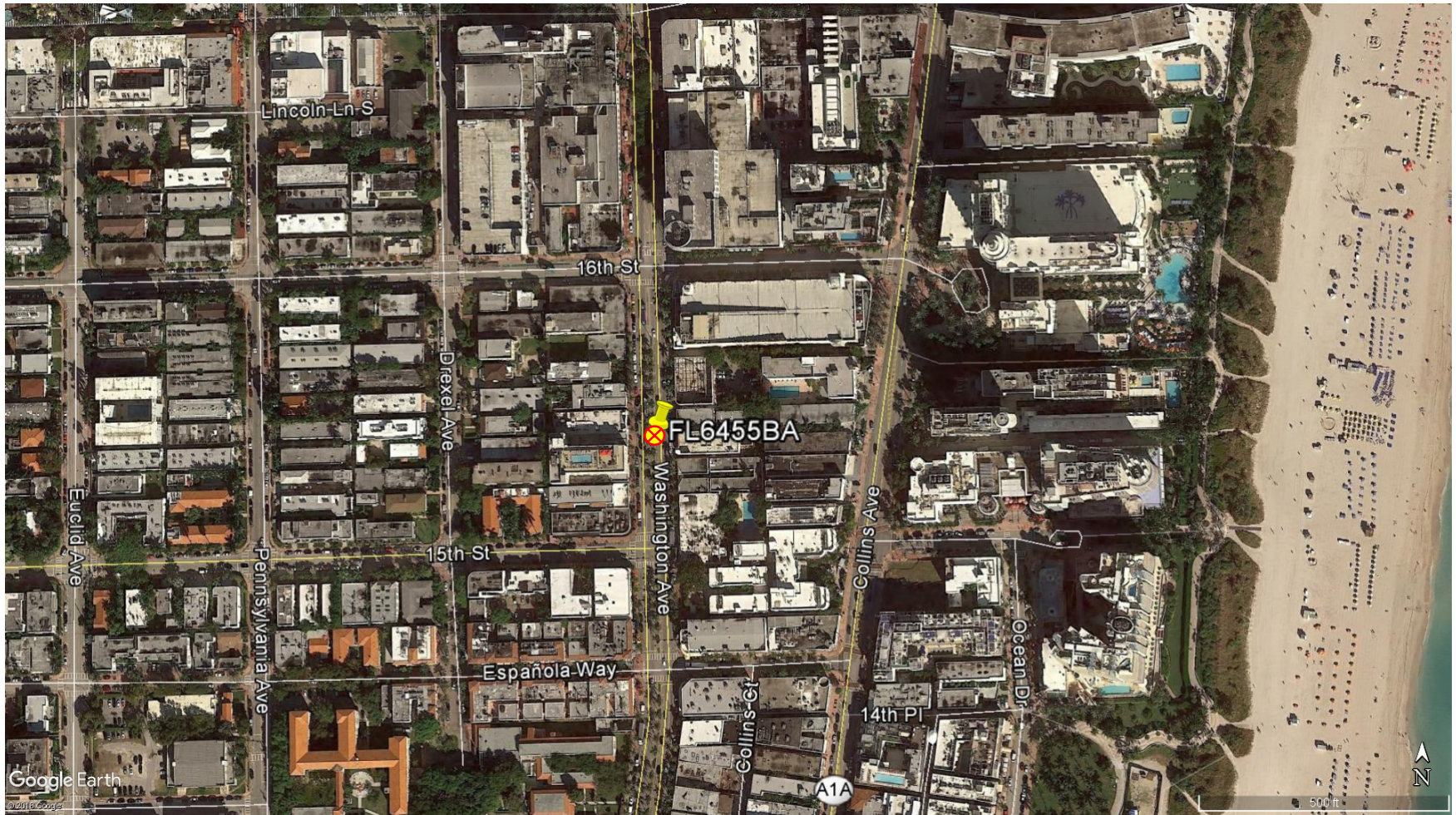

FL6455BA

1532 Washington Ave. Miami Beach, FL 33139

North



FL6455BA

1532 Washington Ave. Miami Beach, FL 33139

East



FL6455BA

1532 Washington Ave. Miami Beach, FL 33139

South



FL6455BA

1532 Washington Ave. Miami Beach, FL 33139

West

