

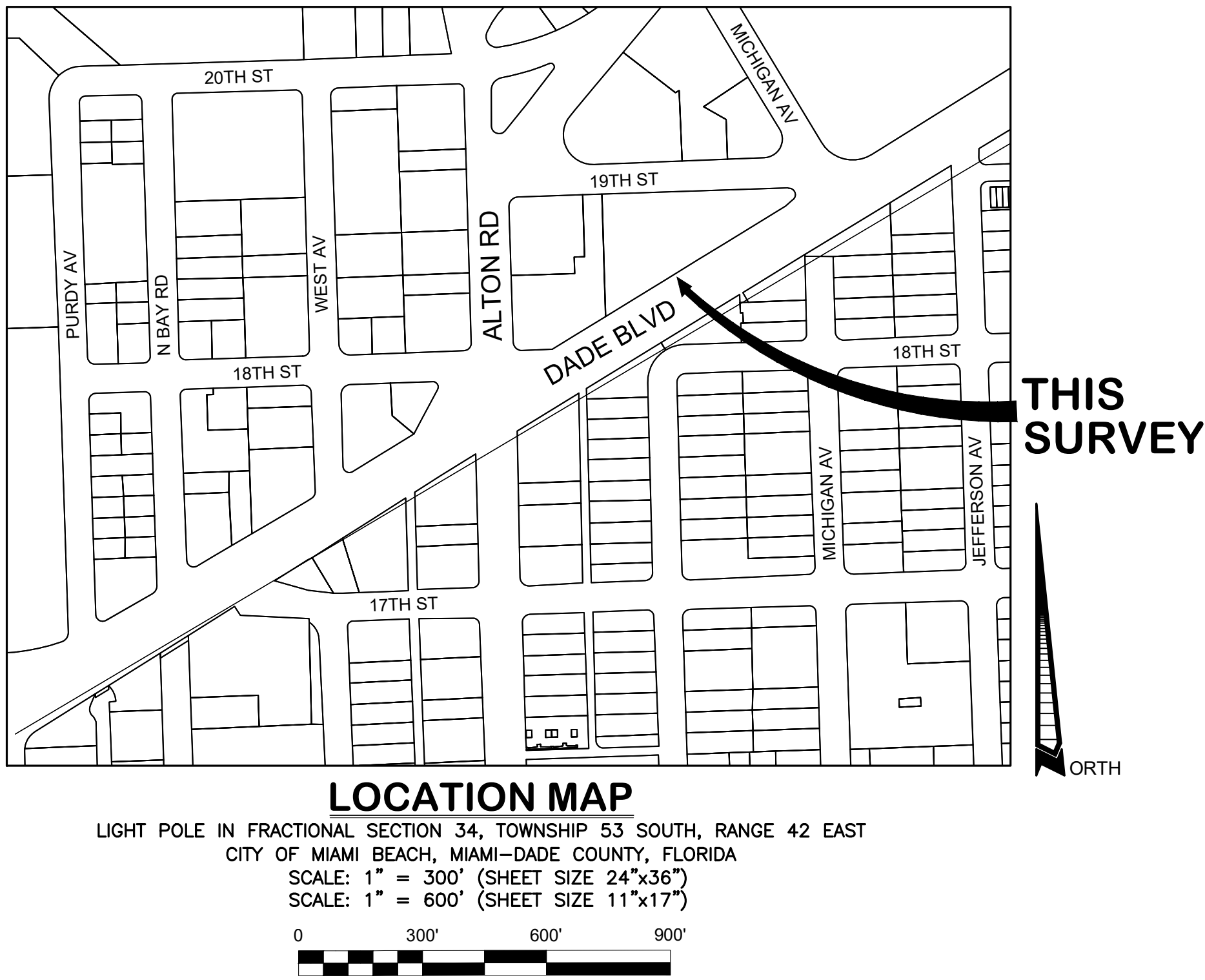

NORTH  
SCALE: 1\"=10' (SHEET SIZE 24"x36")  
SCALE: 1\"=20' (SHEET SIZE 11"x17")



- NOTES:**
- This is a Specific Purpose Radial Survey for the stated purpose of locating improvements within a 50' wide radius of the existing light pole to be used for proposed telecommunications equipment. Client provided the location of the subject light pole.
  - BEARINGS shown hereon are based upon the centerline of Dade Boulevard with an assumed bearing of N58°39'41"E.
  - Right-of-way widths determined from: Plat Book 6 Page 115 and City of Miami Beach Atlas Map.
  - Geodetic and Florida State Plane coordinates shown hereon are based on G.P.S. observation using the Florida Permanent Reference Network (FRPN) base station "FLMB". Accuracy within tolerances as set forth by the F.A.A. Referenced to North American Datum 1983, 1990 Adjustment.
  - 2016 Aerial Photograph shown hereon obtained from Florida Department of Transportation.
  - All dimensions are shown in feet and decimal feet.
  - No attempt was made by this firm to determine the nature, size, and location of underground utilities. Underground paint mark locations were located at the time of this survey and plotted hereon. Contractor should notify "Sunshine No-Cuts" prior to ANY excavation work. This is not a comprehensive Utility Survey.
  - All documents are recorded in the Public Records of Miami-Dade County, Florida, unless otherwise noted.
  - The lands shown hereon have not been abstracted by this firm regarding matters of interest to other parties, such as easements, rights-of-ways, reservations, etc. A Title Commitment review has not been performed.
  - Roof overhangs, if any, not shown unless otherwise noted.
  - The subject light pole lies in Section 34-53S-42E in the City of Miami Beach, Miami-Dade County, Florida.
  - Right-Of-Way lines do not represent an opinion of ownership by this Firm.
  - Fence and wall ownership is not determined. This survey does not reflect or determine ownership.
  - In some instances graphic representation have been exaggerated to more clearly illustrate the relationship between physical improvements and/or lot lines. Dimensions shall control the location of the improvements over scaled positions.
  - THIS IS NOT A BOUNDARY SURVEY.

- LEGEND:**
- CONCRETE
  - CB - CATCH BASIN
  - CLP - CONCRETE LIGHT POLE
  - D - DIAMETER
  - DCR - MIAMI-DADE COUNTY RECORDS
  - DMH - DRAINAGE MANHOLE
  - EHH - ELECTRIC HANDHOLE
  - F.A.A. - FEDERAL AVIATION ADMINISTRATION
  - FEMA - FEDERAL EMERGENCY MANAGEMENT AGENCY
  - FH - FIRE HYDRANT
  - G.P.S. - GLOBAL POSITIONING SYSTEM
  - H - HEIGHT
  - HCR - HANDICAP RAMP
  - ICV - IRRIGATION CONTROL VALVE
  - ID - IDENTIFICATION
  - MLP - METAL LIGHT POLE
  - LB - LICENSED BUSINESS
  - L/S - LANDSCAPING AREA
  - NO - NUMBER
  - PB - PLAT BOOK
  - S - SPREAD
  - SMH - SEWER MANHOLE

**FEMA FLOOD ZONE**

Community No.: 120651  
Community Name: CITY OF MIAMI BEACH  
Panel No: 0317  
Map Number: 12086C0317L  
Flood Zone: AE  
Base Flood Elevation: 8.0' NGVD 1929  
Date of Map Panel: 9/11/2009  
Date of Firm Index: 9/11/2009



**CROWN CASTLE SFL10275**

NEAR ADDRESS: 1159 DADE BOULEVARD, MIAMI BEACH, FLORIDA 33139



TYPE OF SURVEY: SPECIFIC PURPOSE RADIAL SURVEY  
PREPARED FOR: MORRISON HERSHFIELD CORP.  
LEITER PEREZ & ASSOCIATES, INC.  
LAND DEVELOPMENT CONSULTANTS  
CIVIL ENGINEERS - LAND SURVEYORS  
LAND PLANNERS - ENVIRONMENTAL  
520 N.W. 18TH STREET ROAD, SUITE 209, MIAMI, FLORIDA 33139  
MIAMI-DADE (305) 652-5135 BROWARD (854) 524-2202 FAX: (305) 652-0411  
WEBSITE: www.leiterperez.com LICENSED BUSINESS NO. 6767

REVISIONS:		NOTES	
DATE:	JOB ORDER:	DESCRIPTION:	F.B. PG.

NOTES:  
1. ELEVATIONS WHEN SHOWN REFER TO THE NATIONAL GEODEIC VERTICAL DATUM (NGVD) 1929.  
2. THIS FIRM HAS MADE NO ATTEMPT TO LOCATE FOOTINGS AND/OR FOUNDATIONS (UNLESS OTHERWISE NOTED).  
3. THE LANDS SHOWN HEREON HAVE NOT BEEN ABSTRACTED BY THIS FIRM REGARDING MATTERS OF INTEREST. OTHER PARTIES, SUCH AS EASEMENTS, RIGHTS-OF-WAY, ETC.  
4. THIS SURVEY WAS PREPARED FOR AND CERTIFIED TO THE PARTY AND/OR PARTIES INDICATED HEREON AND IS NOT TRANSFERABLE OR ASSIGNABLE.  
5. ALL IRON PIPES & NAILS AND DISCS SET BY THIS FIRM, SET WITH CAP OR DISC WITH LB# 6767.

**SURVEYOR'S CERTIFICATE:**  
WE HEREBY CERTIFY THAT THIS SURVEY IS TRUE AND CORRECT TO THE BEST OF OUR KNOWLEDGE AND BELIEF AS RECENTLY SURVEYED AND DRAWN UNDER OUR DIRECTION AND THAT THIS SURVEY MEETS THE STANDARDS OF PRACTICE AS SET FORTH BY THE FLORIDA STATE BOARD OF PROFESSIONAL SURVEYORS AND MAPPERS IN CHAPTER 461-17, FLORIDA ADMINISTRATIVE CODE, PURSUANT TO SECTION 470.021, FLORIDA STATUTES.  
LEITER PEREZ & ASSOCIATES, INC.  
BY: GEOFFREY LEITER, PROFESSIONAL SURVEYOR & MAPPER #6395  
STATE OF FLORIDA

