

SCALE: 1"=10' (SHEET SIZE 24"x36")
SCALE: 1"=20' (SHEET SIZE 11"x17")

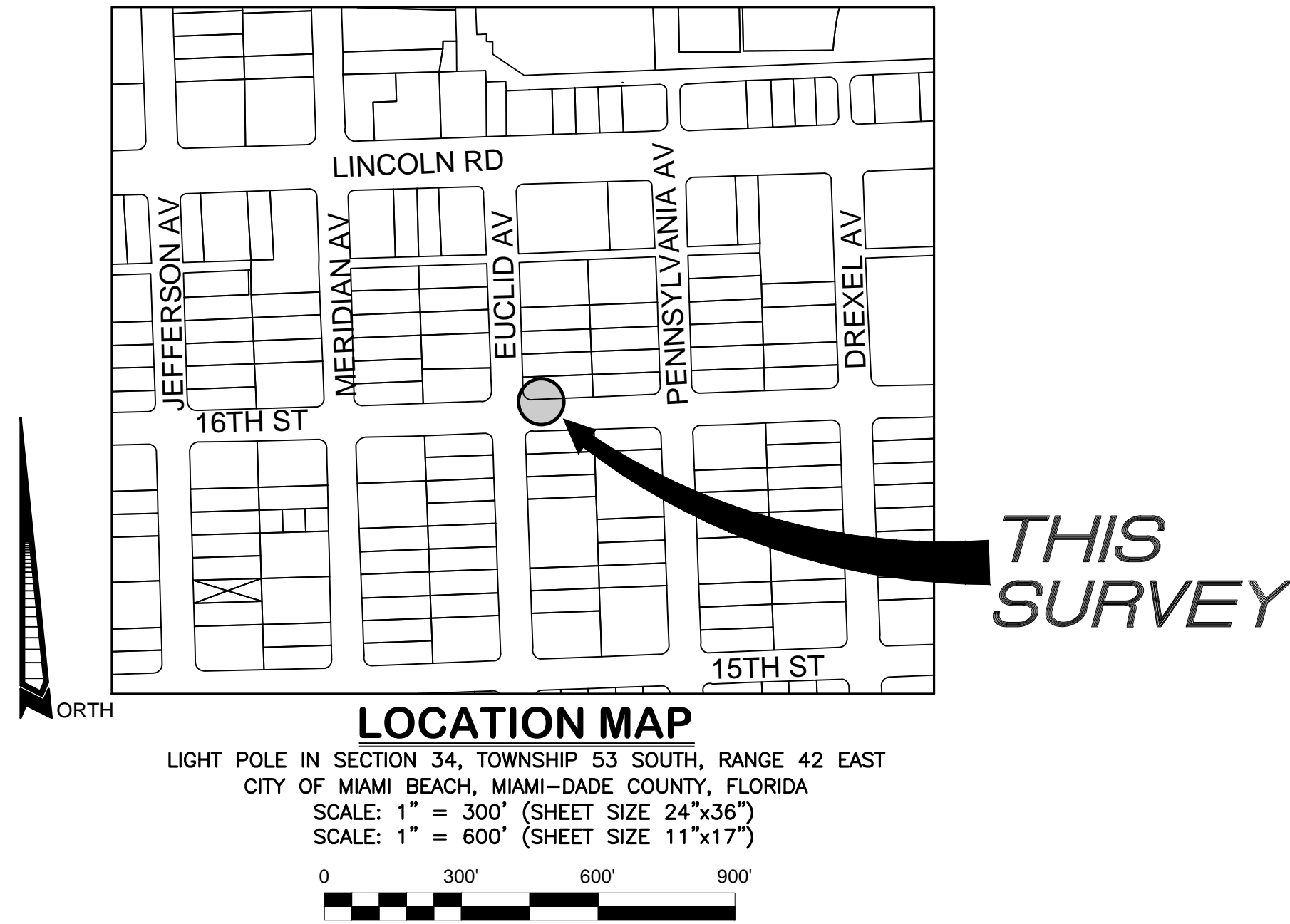

NOTES:

- This is a Specific Purpose Survey for the stated purpose of locating improvements within a 50' wide radius of a proposed light pole to be used for proposed telecommunications equipment. Client provided the location of the subject light pole.
- BEARINGS shown hereon are based upon the centerline of 16th STREET as shown in Plat Book 9 Page 69 with an assumed bearing of S88°04'00"W.
- Right-of-way widths determined from said Plat Book 9 Page 69.
- Geodetic and Florida State Plane coordinates shown hereon are based on G.P.S. observation using the Florida Permanent Reference Network (FPRN) base station "FLMB". Accuracy within tolerances as set forth by the F.A.A. Referenced to North American Datum 1983, 1990 Adjustment.
- 2016 Aerial Photograph shown hereon obtained from Florida Department of Transportation.
- All dimensions are shown in feet and decimal feet.
- No attempt was made by this firm to determine the nature, size, and location of underground utilities. Underground paint mark locations were located at the time of this survey and plotted hereon. Contractor should notify "Sunshine No-Cuts" prior to ANY excavation work. This is not a comprehensive Utility Survey.
- All documents are recorded in the Public Records of Miami-Dade County, Florida, unless otherwise noted.
- The lands shown hereon have not been abstracted by this firm regarding matters of interest to other parties, such as easements, rights-of-ways, reservations, etc. A Title Commitment review has not been performed.
- Roof overhangs, if any, not shown unless otherwise noted.
- The proposed subject light pole lies in Section 34-53S-42E in the City of Miami Beach, Miami-Dade County, Florida.
- Right-Of-Way lines do not represent an opinion of ownership by this Firm.
- Fence and wall ownership is not determined. This survey does not reflect or determine ownership.
- In some instances graphic representation have been exaggerated to more clearly illustrate the relationship between physical improvements and/or lot lines. Dimensions shall control the location of the improvements over scaled positions.
- THIS IS NOT A BOUNDARY SURVEY.

LEGEND:

- C&G - CONCRETE CURB & GUTTER
- CBS - CONCRETE BLOCK & STUCCO
- CI - CURB INLET
- D - DIAMETER
- DCR - MIAMI-DADE COUNTY RECORDS
- DMH - DRAINAGE MANHOLE
- EHH - ELECTRIC HANDHOLE
- F.A.A. - FEDERAL AVIATION ADMINISTRATION
- FDC - FIRE DEPARTMENT CONNECTION
- FEMA - FEDERAL EMERGENCY MANAGEMENT AGENCY
- FHH - FIBER OPTIC HANDHOLE
- GPS - GLOBAL POSITIONING SYSTEM
- H - HEIGHT
- L/S - LANDSCAPING AREA
- LB - LICENSED BUSINESS
- MLP - METAL LIGHT POLE
- NO. - NUMBER
- ORB - OFFICIAL RECORDS BOOK
- PB - PLAT BOOK
- PKD - PARKER-KALON NAIL & DISC
- PL - PLANTER
- S - CANOPY SPREAD
- SMH - SEWER MANHOLE
- SN - SIGN
- WV - WATER VALVE

FEMA FLOOD ZONE

Community No.: 120651
Community Name: CITY OF MIAMI BEACH
Panel No: 0317
Suffix: L
Map Number: 12086C0317L
Flood Zone: AE
Base Flood Elevation: 8.0' NGVD 1929
Date of Map Panel: 9/11/2009
Date of Firm Index: 9/11/2009

This item has been digitally signed and sealed by Geoffrey Leiter, P.S.M. No. 6395 State of Florida, on 02-04-2019 using a Digital Signature.
Printed copies of this document are not considered signed and sealed and the SHA authentication code must be verified on any electronic copies.

TYPE OF SURVEY: SPECIFIC PURPOSE RADIAL SURVEY		REVISIONS:				NOTES	SURVEYOR'S CERTIFICATE:
PREPARED FOR:	MORRISON HERSHFELD CORP.	DATE:	JOB ORDER:	DESCRIPTION:	F.B. PG.		
LEITER PEREZ & ASSOCIATES, INC. LAND DEVELOPMENT CONSULTANTS CIVIL ENGINEERS - LAND SURVEYORS LAND PLANNERS - ENVIRONMENTAL		SURVEY DATE: 2-8-2019	JOB ORDER: 19-123	NEAR ADDRESS		1. ELEVATIONS WHEN SHOWN REFER TO THE NATIONAL GEODETIC VERTICAL DATUM (NGVD) 1929.	WE HEREBY CERTIFY THAT THIS SURVEY IS TRUE AND CORRECT TO THE BEST OF OUR KNOWLEDGE AND BELIEF AS RECENTLY SURVEYED AND DRAWN UNDER OUR DIRECTION AND THAT THIS SURVEY MEETS THE "STANDARDS OF PRACTICE" AS SET FORTH BY THE FLORIDA STATE BOARD OF PROFESSIONAL SURVEYORS AND MAPPERS IN CHAPTER 46-17, FLORIDA ADMINISTRATIVE CODE, PURSUANT TO SECTION 470.027, FLORIDA STATUTES.
520 N.W. 16TH STREET ROAD, SUITE 200, MIAMI, FLORIDA 33169 MIAMI-DADE (305) 652-5133 BROWARD (954) 324-2202 FAX: (305) 652-0111 WEBSITE: www.leiterperez.com LICENSED BUSINESS NO. 6787		FILE NO.: B-2531	FILE NAME: 19-123.dwg			2. THIS FIRM HAS MADE NO ATTEMPT TO LOCATE FOOTINGS AND/OR FOUNDATIONS (UNLESS OTHERWISE NOTED).	
		F.B. 355	PG. 77			3. THE LANDS SHOWN HEREON HAVE NOT BEEN ABSTRACTED BY THIS FIRM REGARDING MATTERS OF INTEREST, OTHER PARTIES, SUCH AS EASEMENTS, RIGHTS-OF-WAY, ETC.	LEITER PEREZ & ASSOCIATES, INC. BY: GEOFFREY LEITER, PROFESSIONAL SURVEYOR & MAPPER #6395 STATE OF FLORIDA
						4. THIS SURVEY WAS PREPARED FOR AND CERTIFIED TO THE PARTY AND/OR PARTIES INDICATED HEREON AND IS NOT TRANSFERABLE OR ASSIGNABLE.	
						5. ALL IRON PIPES & NAILS AND DISCS SET BY THIS FIRM, SET WITH CAP OR DISC WITH LB# 6787.	

CROWN CASTLE FL6485BA

NEAR ADDRESS: 643 16th STREET, MIAMI BEACH, FLORIDA 33139

NOT VALID WITHOUT THE SIGNATURE AND THE ORIGINAL RAISED SEAL OF A FLORIDA LICENSED SURVEYOR AND MAPPER.

SHEET 1 OF 1